

Specifications

Current rating:4A AC,DC
Voltage rating:250V AC,DC
Temperature range:-40°C~+105°C
Contact resistance:10mΩ Max.
Insulation resistance:1000MΩ Min.
Withstanding voltage:5000V AC/minute
Contact CJT for details

Standards



Assembly layout

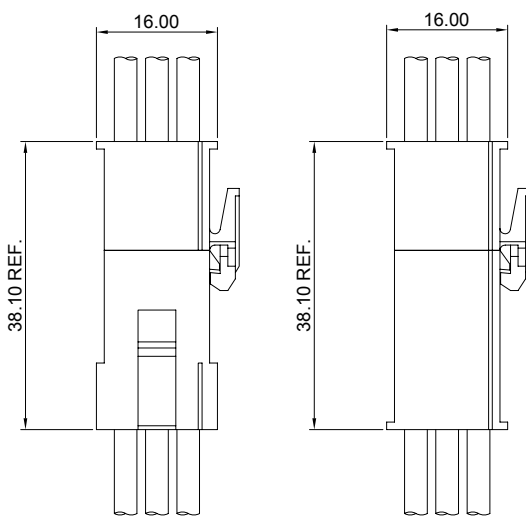

WIRE TO WIRE

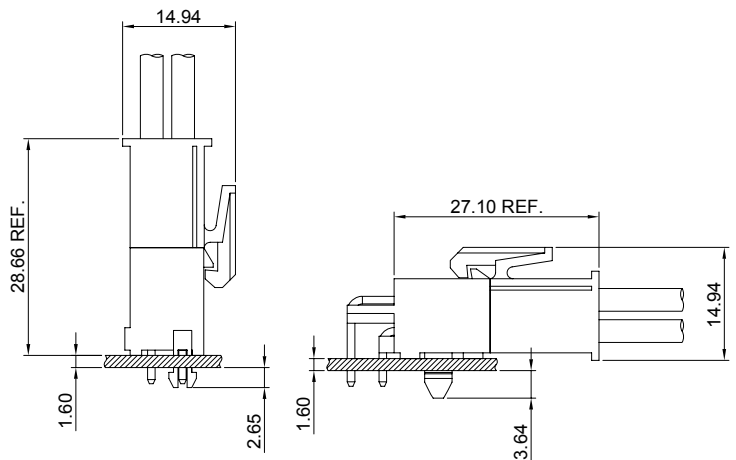

WIRE TO BOARD

180° Wafer

2P and 3P Circuit , Single Row

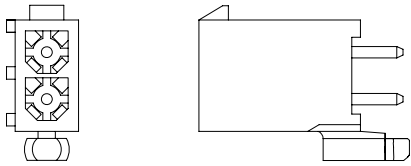

2x2P,2x3P,2x4P,2x5P and 2x6P Circuit , Dual Row

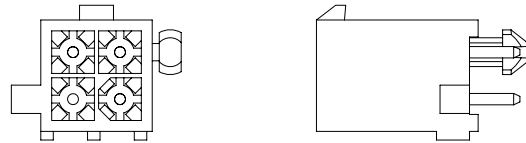

3x3P,3x4P and 3x5P Circuit , Triple Row

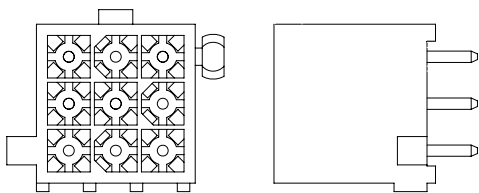

2x7P,2x8P,2x9P,2x10P,2x11P and 2x12P Circuit , Dual Row

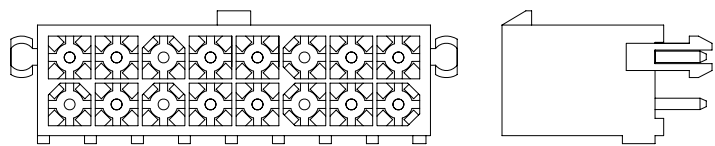

90° Wafer

2P and 3P Circuit , Single Row

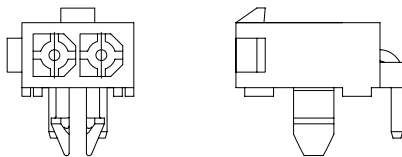

2x2P,2x3P,2x4P,2x5P and 2x6P Circuit , Dual Row

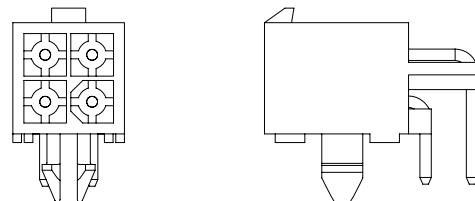

2x7P,2x8P,2x9P,2x10P,2x11P and 2x12P Circuit , Dual Row

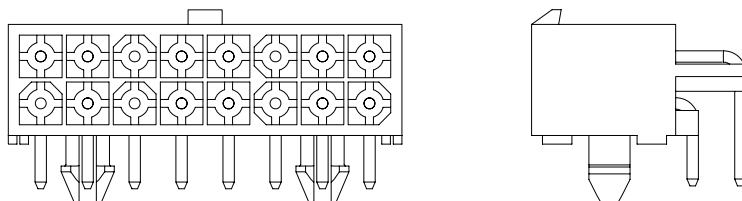



C4140 SERIES

4.14mm pitch wire to wire and wire to board connector

C4140HF-2

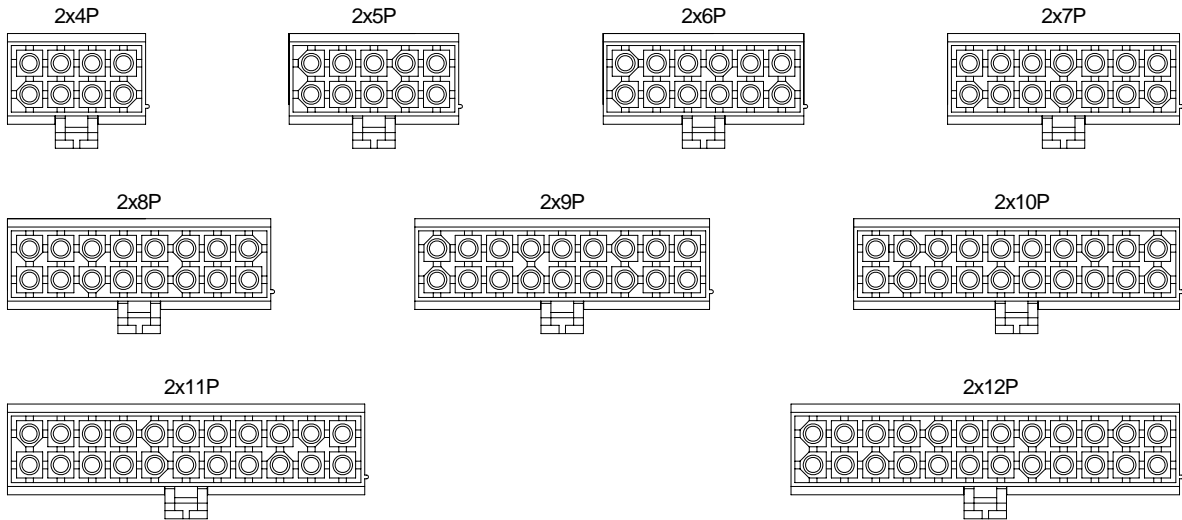

C4140WV-2

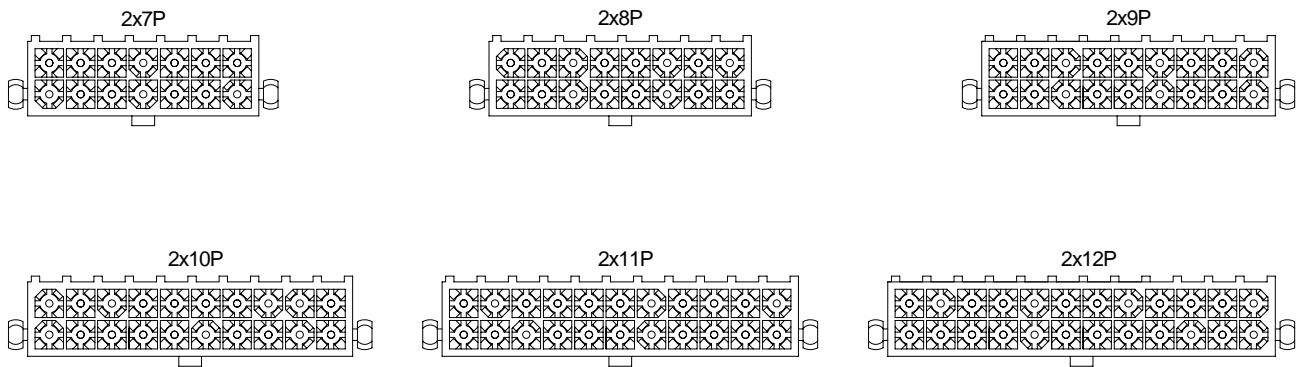

C4140WR-2

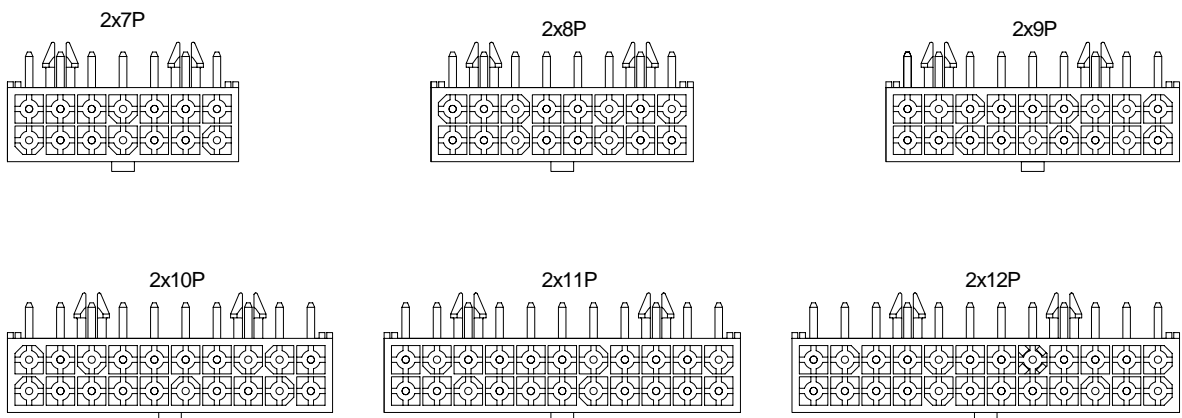

C4140F-T

4.14mm pitch Crimp Terminal

Reference Informations:

*Used in CJT C4140HF series Housing

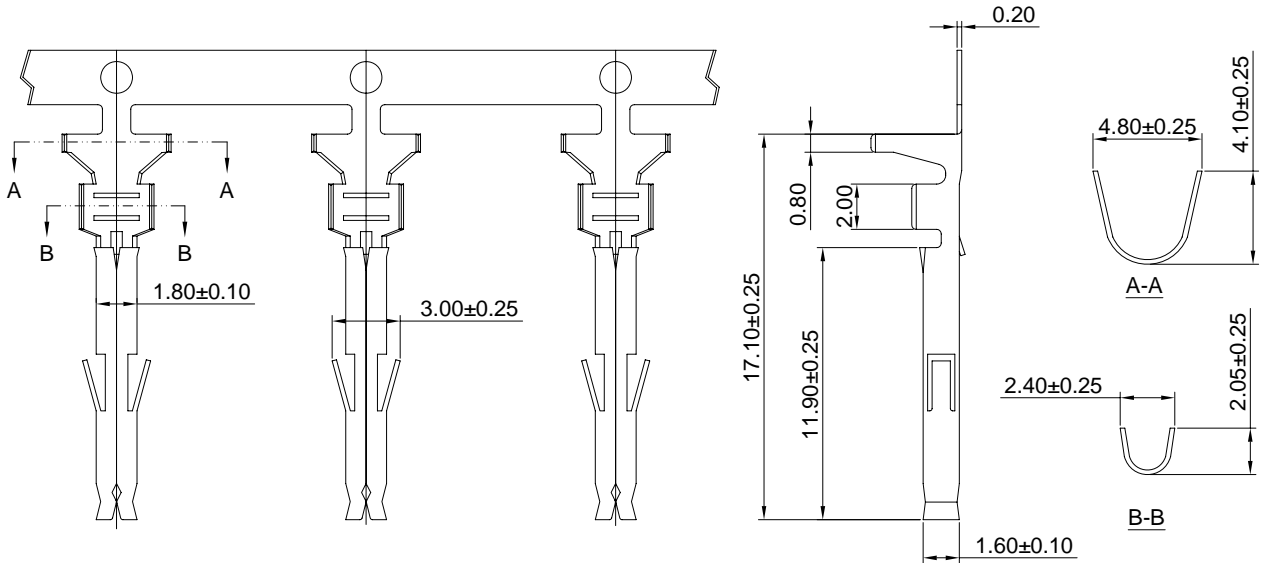

Ordering information & Specifications:

Unit:mm

Part NO.	Wire Range	Insulation O.D.	Material	Finish	Qty/reel
C4140F-TB	AWG#18-#22	3.00mm(max)	Brass	Tin over Nickel	4,000 PCS
C4140F-TP	AWG#18-#22	3.00mm(max)	Phosphor Bronze	Tin over Nickel	4,000 PCS
C4140F-GB	AWG#18-#22	3.00mm(max)	Brass	Gold over Nickel	4,000 PCS
C4140F-GP	AWG#18-#22	3.00mm(max)	Phosphor Bronze	Gold over Nickel	4,000 PCS

Optional Gold plating available but MOQ requested

C4140M-T

4.14mm pitch Crimp Terminal

Reference Informations:

*Used in CJT C4140HM C4140HMA series Housing

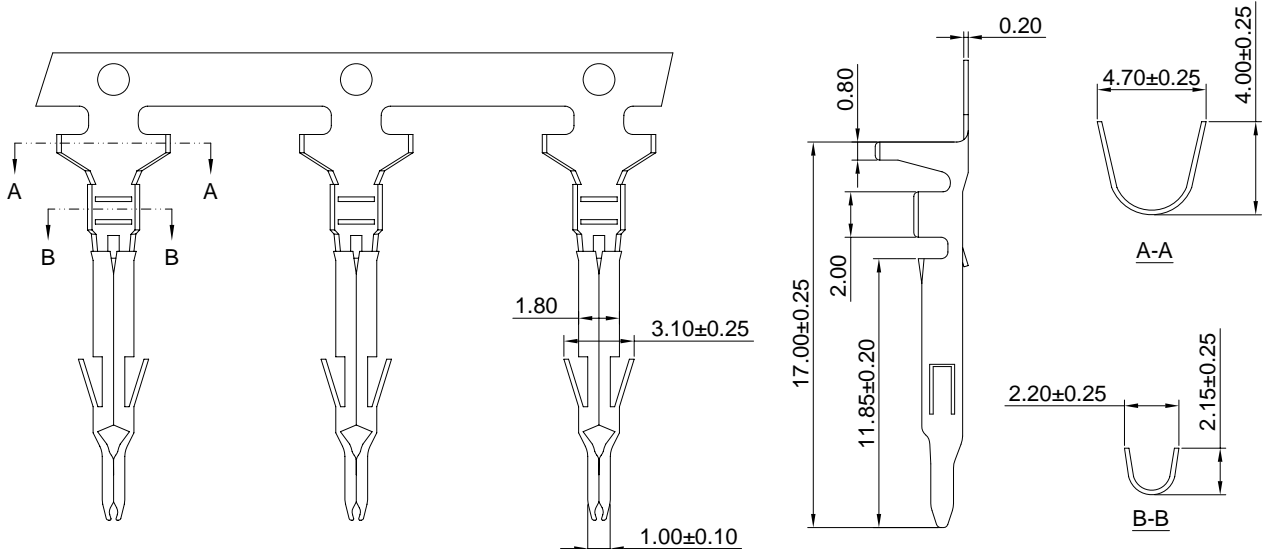

Ordering information & Specifications:

Unit:mm

Part NO.	Wire Range	Insulation O.D.	Material	Finish	Qty/reel
C4140M-TB	AWG#18-#22	3.00mm(max)	Brass	Tin over Nickel	4,000 PCS
C4140M-TP	AWG#18-#22	3.00mm(max)	Phosphor Bronze	Tin over Nickel	4,000 PCS
C4140M-GB	AWG#18-#22	3.00mm(max)	Brass	Gold over Nickel	4,000 PCS
C4140M-GP	AWG#18-#22	3.00mm(max)	Phosphor Bronze	Gold over Nickel	4,000 PCS

Optional Gold plating available but MOQ requested

C4140H

4.14mm Pitch Housing

Reference Informations:

- *Material: Nylon 66, UL94V-2 or UL94V-0
- *Color: Natural (translucent or white)

Ordering Information:

C4140HF-XP - **
 1 2
 1. Part No.
 2. Material:
 V2: UL94V-2
 V0: UL94V-0

Ordering Information:

C4140HM(A)-XP - **
 1 2
 1. Part No.
 2. Material:
 V2: UL94V-2
 V0: UL94V-0

Unit: mm

C4140HM(A)	C4140HF
<p>C4140HM-1P</p>	<p>C4140HF-1P</p>
<p>C4140HM-2P</p>	<p>C4140HF-2P</p>
<p>C4140HMA-2P</p>	<p>C4140HF-2P</p>
<p>C4140HM-3P</p>	<p>C4140HF-3P</p>
<p>C4140HMA-3P</p>	<p>C4140HF-3P</p>

C4140H

4.14mm Pitch Housing

Reference Informations:

- *Material: Nylon 66, UL94V-2 or UL94V-0
- *Color: Natural (translucent or white)

Ordering Information:

- C4140HF-2xXP - **
- | | |
|---|---|
| 1 | 2 |
|---|---|
- 1.Part No.
 - 2.Material:
 - V2:UL94V-2
 - V0:UL94V-0

Ordering Information:

- C4140HM(A)-2xXP - **
- | | |
|---|---|
| 1 | 2 |
|---|---|
- 1.Part No.
 - 2.Material:
 - V2:UL94V-2
 - V0:UL94V-0

Unit: mm

C4140HM(A)	C4140HF
<p>C4140HM-2x2P</p>	<p>C4140HF-2x2P</p>
<p>C4140HMA-2x2P</p>	
<p>C4140HM-2x3P</p>	<p>C4140HF-2x3P</p>
<p>C4140HMA-2x3P</p>	

C4140H

4.14mm Pitch Housing

Unit: mm

C4140HM(A)	C4140HF
<p>C4140HM-3x3P</p>	<p>C4140HF-3x3P</p>
<p>C4140HMA-3x3P</p>	
<p>C4140HM-3x4P</p>	<p>C4140HF-3x4P</p>
<p>C4140HMA-3x4P</p>	
<p>C4140HM-3x5P</p>	<p>C4140HF-3x5P</p>
<p>C4140HMA-3x5P</p>	

C4140WV and WR

4.14mm Pitch Wafer

Reference Informations:

*Material:Nylon 66,UL94V-0

*Color:Natural(white)

Assembly layout

Unit: mm

Dimensions:

PART NO.		Dim.A
C4140WV-2x2P	C4140WR-2x2P	4.14
C4140WV-2x3P	C4140WR-2x3P	8.28
C4140WV-2x4P	C4140WR-2x4P	14.42
C4140WV-2x5P	C4140WR-2x5P	16.56
C4140WV-2x6P	C4140WR-2x6P	20.70

180° Wafer

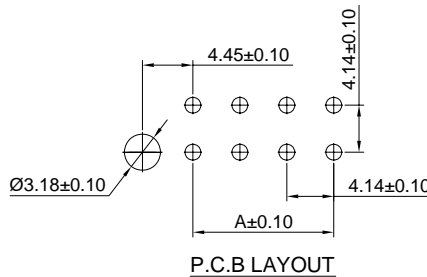

P.C.B LAYOUT
C4140WV(2x2P.....2x6P)

90° Wafer

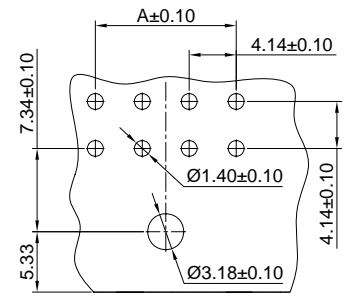

P.C.B LAYOUT
C4140WR(2x2P.....2x6P)

C4140WV

C4140WV-2P

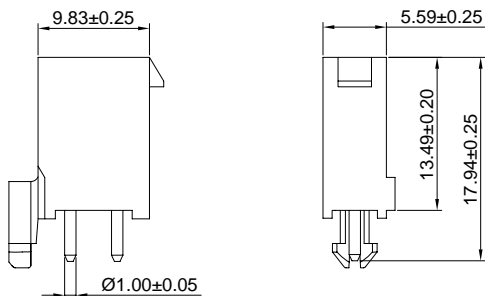
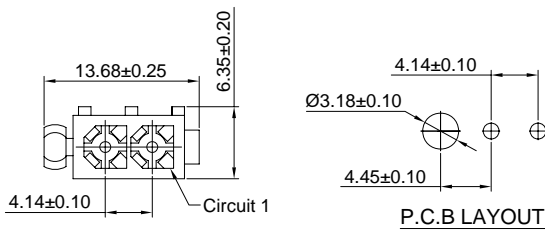

C4140WR

C4140WR-2P

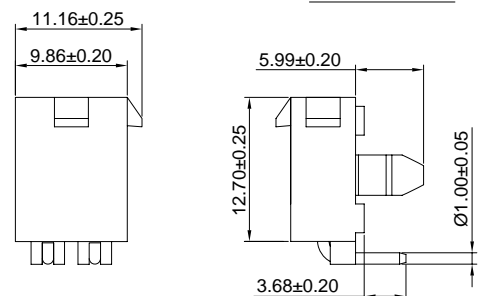
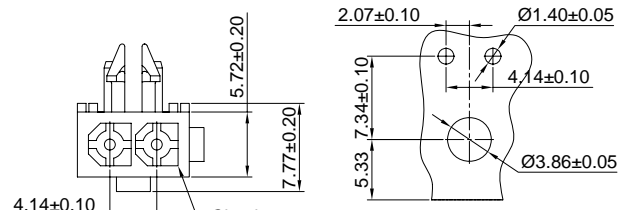

C4140WV and WR

4.14mm Pitch Wafer

Reference Informations:

*Material: Nylon 66, UL94V-0

*Color: Natural(white)

Unit: mm

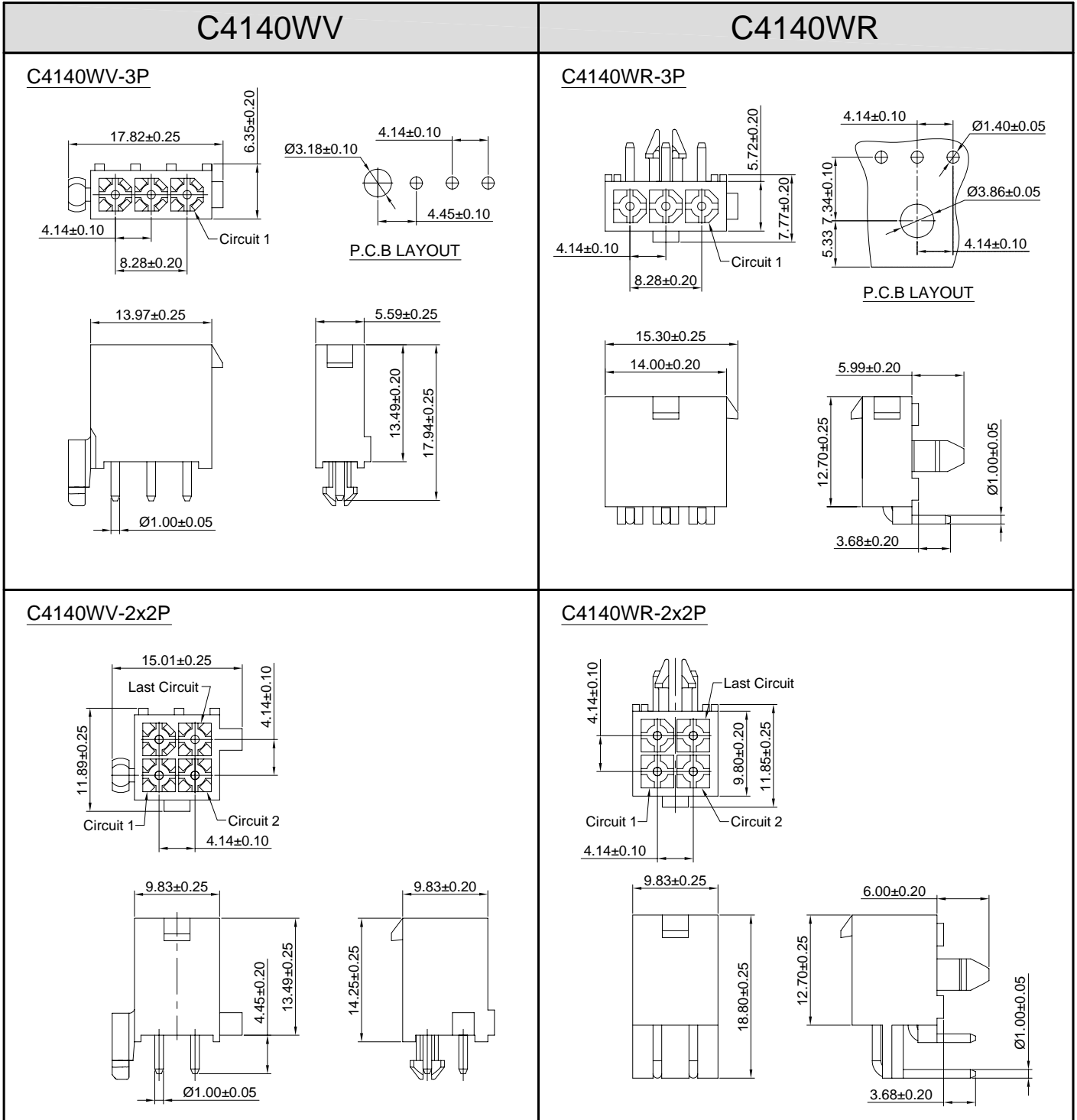

C4140WV and WR

4.14mm Pitch Wafer

Reference Informations:

*Material: Nylon 66, UL94V-0

*Color: Natural(white)

Unit: mm

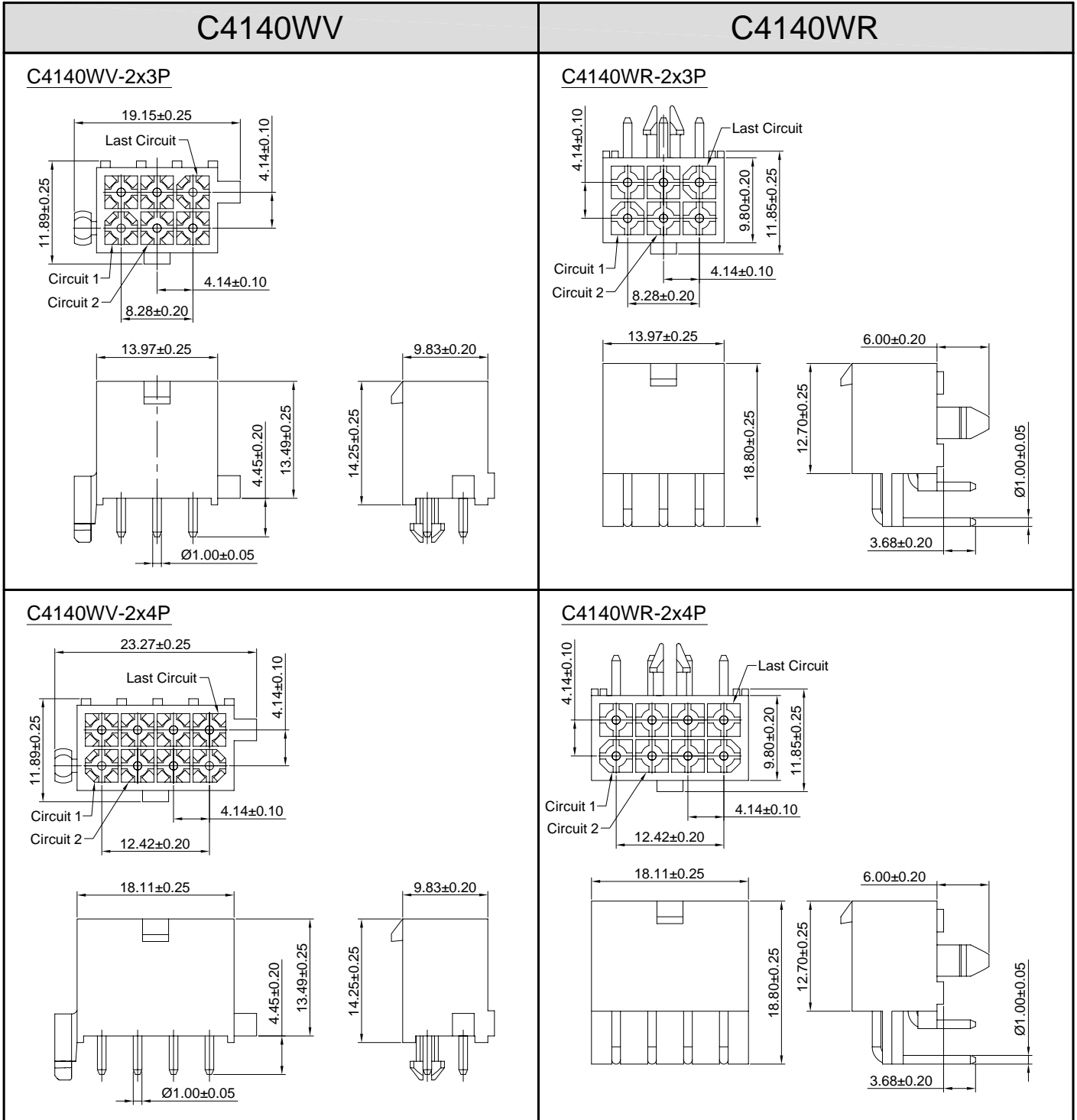

C4140WV and WR

4.14mm Pitch Wafer

Reference Informations:

*Material: Nylon 66, UL94V-0

*Color: Natural(white)

Unit: mm

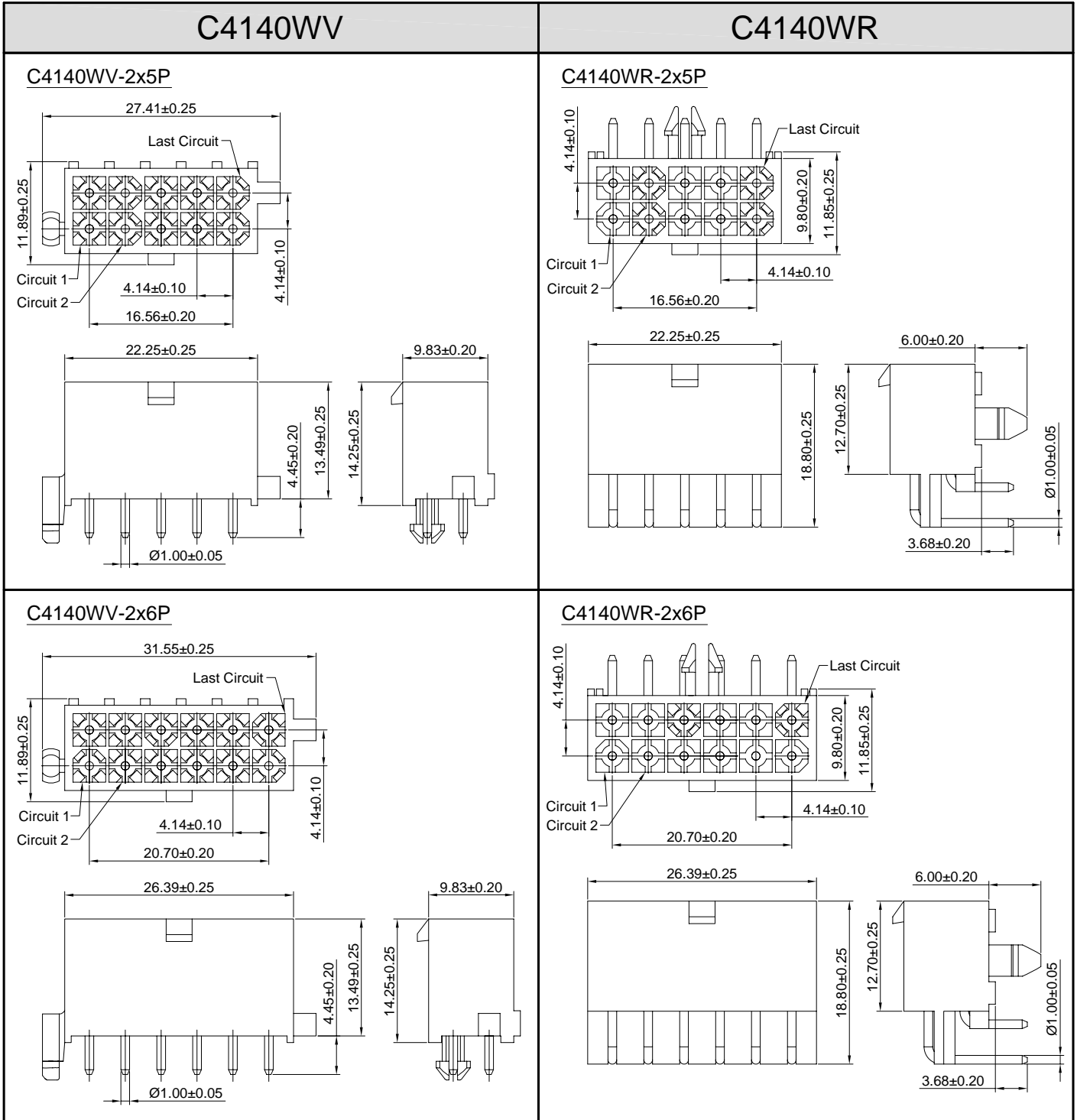

C4140HF-2

4.14mm Pitch Dual Row Housing

Reference Informations:

- *Material:Nylon 66,UL94V-0
- *Suitable CJT C4140F series Terminal
- *Mates with CJT C4140HM C4140 series Wafer
- *Color:Natural(white)

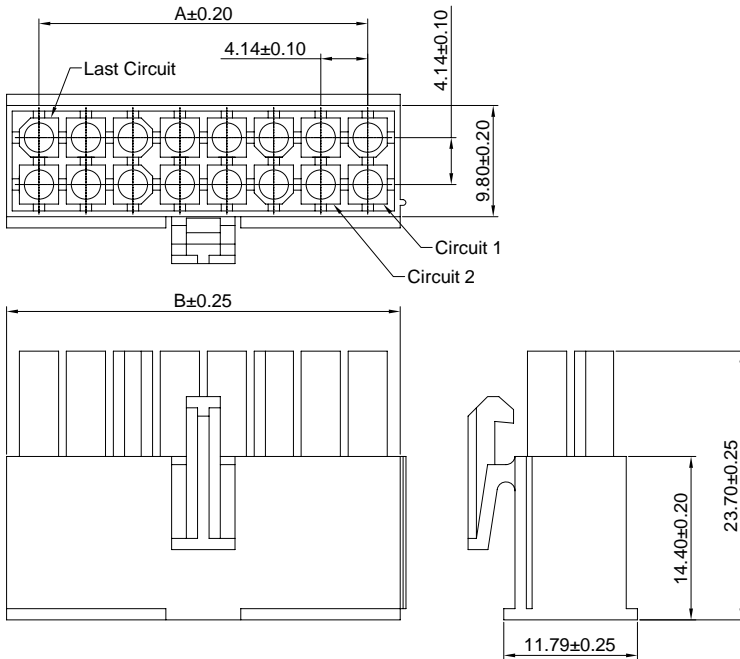
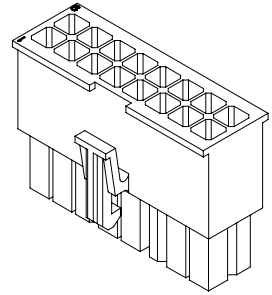

Ordering Information & Dimensions:

PART NO.	Dimensions	
	A	B
C4140HF-2X4P	12.42	18.14
C4140HF-2X5P	16.56	22.28
C4140HF-2X6P	20.70	26.42
C4140HF-2X7P	24.84	30.56
C4140HF-2X8P	28.98	34.70
C4140HF-2X9P	33.12	38.84
C4140HF-2X10P	37.26	42.98
C4140HF-2X11P	41.40	47.12
C4140HF-2X12P	45.54	51.26

Unit: mm

C4140WV-2

4.20mm pitch 180° Dual Row Wafer

Reference Informations:

- *Material:Pin:Brass/Tin over Nickel
Insulator:Nylon 66, UL94V-0
- *Mates with CJT C4140HF series Housing
- *Color:Natural(white)

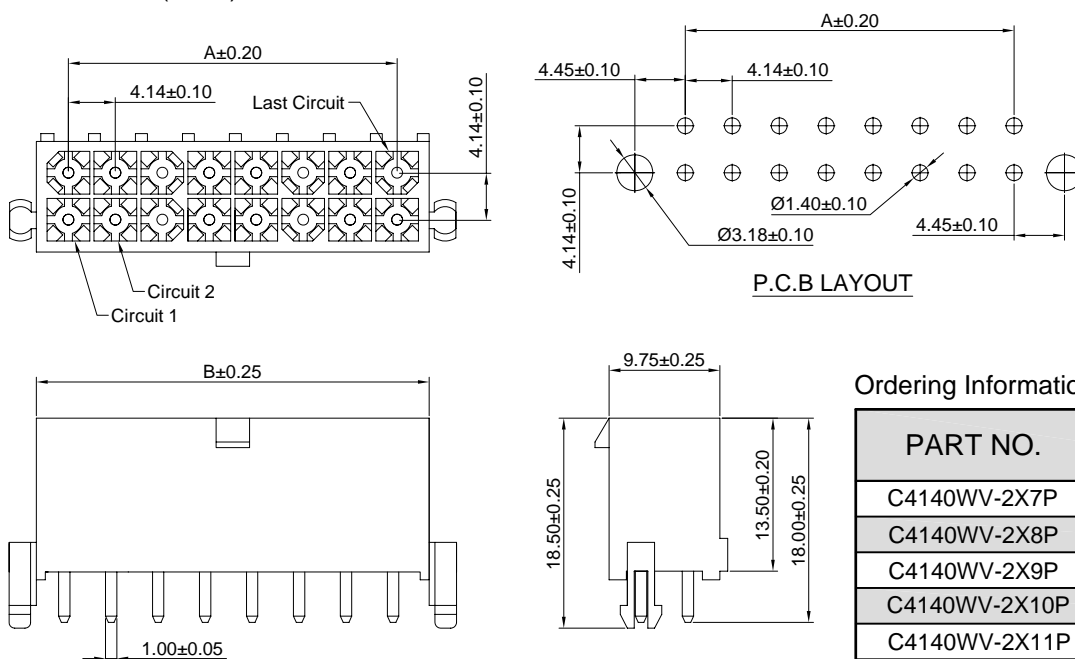
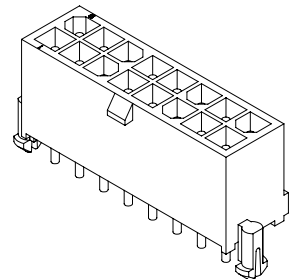

Ordering Information & Dimensions:

PART NO.	Dimensions	
	A	B
C4140WV-2X7P	24.84	30.56
C4140WV-2X8P	28.98	34.70
C4140WV-2X9P	33.12	38.84
C4140WV-2X10P	37.26	42.98
C4140WV-2X11P	41.40	47.12
C4140WV-2X12P	45.54	51.26

Unit: mm



C4140 SERIES

4.14mm pitch wire to wire and wire to board connector

C4140WR-2

4.14mm pitch 90° Dual Row Wafer

Reference Informations:

- *Material:Pin:Brass/Tin over Nickel
Insulator:Nylon 66, UL94V-0
- *Mates with CJT C4140HF series Housing
- *Color:Natural(white)

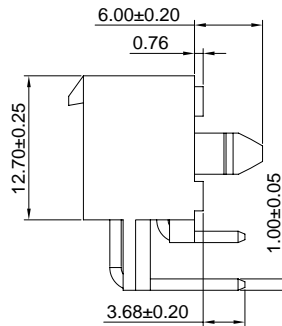
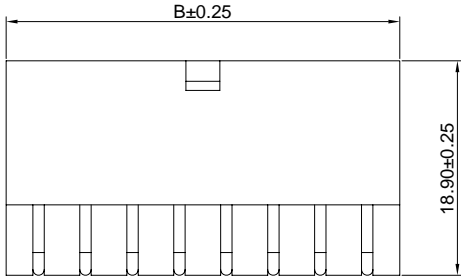
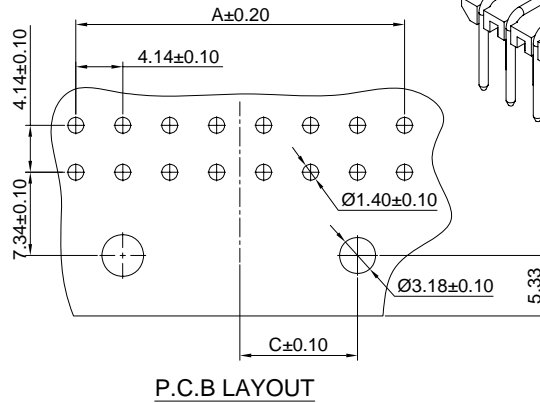
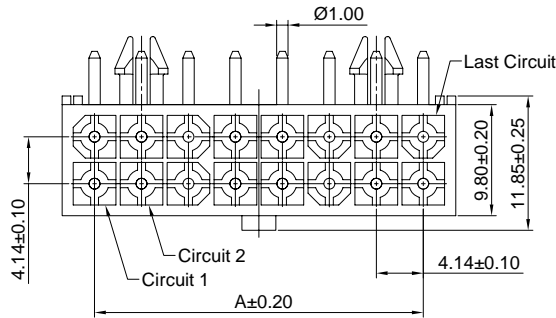
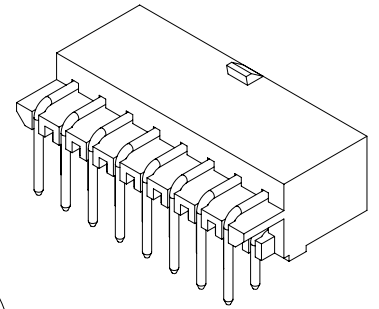

Ordering Information & Dimensions:

PART NO.	Dimensions		
	A	B	C
C4140WR-2X7P	24.84	30.56	8.28
C4140WR-2X8P	28.98	34.70	10.35
C4140WR-2X9P	33.12	38.84	8.28
C4140WR-2X10P	37.26	42.98	10.35
C4140WR-2X11P	41.40	47.12	10.35
C4140WR-2X12P	45.54	51.26	10.35

Unit: mm