

Rev No A/0	Revision note	Date	Signature	Checked
---------------	---------------	------	-----------	---------

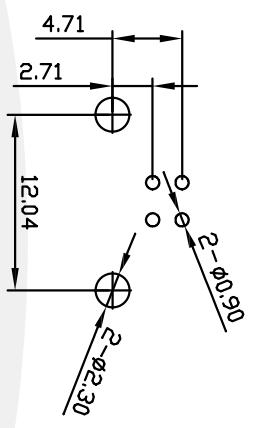

PC Board Layout

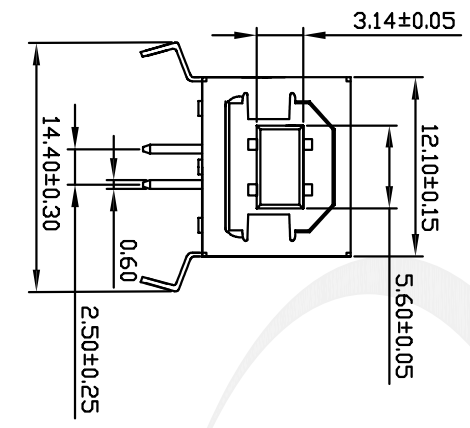
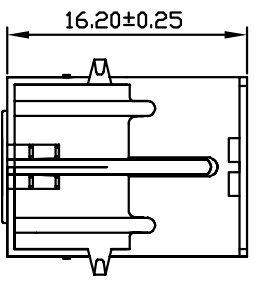
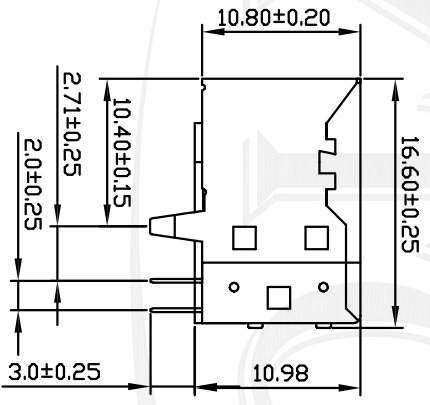

**NOTES:**

**Electrical**

Current Rating: 1.50Ampereper at 250V AC  
Voltage Rating: 30V  
Contact Resistance: 30Milliohms Max  
Insulation Resistance: 1000Megohms Min  
Dielectric Withstanding Voltage: 500V AC (for 1 minute)  
Operation Temperature: -20°C ~ +60°C

**Mechanical**

Contact Material: Phosphor Bronze  
Contact Plating: Au or Sn Over Ni  
Insulator Material: PBT (UL94V-0)  
Mating Force: 3.57Kg Max  
Umating Force: 1.02Kg Min

6422-104FRXX X XX X312

<ul style="list-style-type: none"> <li>Contact Plating</li> <li>G0=Gold Flash</li> <li>G1=3u" Gold</li> <li>G2=5u" Gold</li> <li>G3=10u" Gold</li> <li>G4=15u" Gold</li> <li>G5=30u" Gold</li> <li>S0=GoldFlash/Tin</li> <li>S1=3u" Gold/Tin</li> <li>S2=5u" Gold/Tin</li> <li>S3=10u" Gold/Tin</li> <li>S4=15u" Gold/Tin</li> <li>S5=30u" Gold/Tin</li> <li>SN=Tin</li> </ul>	<ul style="list-style-type: none"> <li>Shell Material</li> <li>B=Brass</li> <li>P=PH: B</li> <li>S=SPCC</li> </ul>	<ul style="list-style-type: none"> <li>Shell Plating</li> <li>NI=Nickel</li> <li>SN=Tin</li> <li>G0=Gold Flash</li> </ul>	<ul style="list-style-type: none"> <li>Color Insulator</li> <li>B=Black</li> <li>W=White</li> <li>U=Blue</li> <li>R=Red</li> <li>Y=Yellow</li> <li>G=Grey</li> </ul>
--	--	---	--

THIS DRAWING IS A CONTROLLED DOCUMENT

DIMENSIONS IN INCHES	TOLERANCES UNLESS OTHERWISE SPECIFIED
0 P/C	±
1 P/C	± 0.20
2 P/C	± 0.25
3 P/C	± 0.30
4 P/C	± 3°

DATE: OCT. 05. 2006  
DATE: OCT. 05. 2006  
DATE: OCT. 05. 2006  
DATE: OCT. 05. 2006

SCALE: 2 : 1  
SIZE: A4

PART NO: 6422-104FRXXXXXXXX312  
DRAWING NO: YT-6422104FR31

YTCO TECHNOLOGY  
HTTP://WWW.YTCO.CO

USB B Type Female 90° DIP

DATE: 1 OF 1  
REV: A