

1A Series TRIAC: 1A 過壓保護 交流開關 【產品概況】

無鉛產品提供SGS環保認證、符合歐盟REACH法規、符合歐盟環保指令標準

概況: HACT110系列器件, 為瞬態抑制型双向可控硅, 高dv/dt能力, 抗干擾能力强;

专门针对IEC61000-4-4电快速瞬变脉冲群抗扰度试验、IEC61000-4-5电涌抗扰试验标准而开发设计。

特点

- 过压保护电路技术, 使设备满足IEC61000-4-5浪涌电流
- 高抗干扰防静电dV/dt技术
- 内置TVS, 无需外部保护缓冲电路, 无需压敏电阻
- 减少了元件数量高达80%, 直接与微控制器的接口
- 普通连接支持在相同的散热垫或几个交流电开关

应用

- 交流电静态开关设备、工业控制系统开/关;
- 小功率驱动、高感性或阻性负载, 如: 继电器、阀门、电磁阀、饮水机、泵、风机、低功率电机、门锁、以及各种灯具; 空气清新器、雾化器、加湿器等小家电、白电产品驱动等控制电路。

DESCRIPTION:

Sensitive gate triac in the TO-92 plastic package, intended for use in AC static switching and industrial control systems, driving low power highly inductive loads like solenoid, pump, fan, and micro-motor.

FEATURES:

dv/dt ≥ 500V/μs; high tolerance to external severe application environment such as EMS High Voltage blocking capability.

MAIN FEATURES

Symbol	Value	Unit
$I_{T(RMS)}$	1	A
I_{GT}	≤ 10	mA
V_{TM}	≤ 1.6	V

ORDERING INFORMATION

H	AC	T	1	10	-	1000	A
↓	↓	↓	↓	↓	↓	↓	↓
生產商 HAOHAI ELECTRONICS	品種表示: Overvoltage protected AC switch 过压保护 交流开关	品種 表示: TRIACs	電流 表示: $I_{T(RMS)}$ =1A	觸發電流 表示: I_{GT} ≤ 10mA		電壓值表示: 1000=1000V 1200=1200V	封裝表示: A:TO-92 N:SOT-223

可代替其它工業型號: ACS108-6SA、ACS108-8SA、ACS108-6SN、ACS108-8SN

主要應用於: 交流電靜態開關設備、工業控制系統開/關; 小功率驅動、高感性或阻性負載, 如:
繼電器、閥門、電磁閥、飲水機、泵、風機、低功率電機、門鎖、各種燈具
典型應用: 空氣清新器、霧化器、加湿器等小家電、白電產品驅動等控制電路

TO-92 (TO-226 / TO-226AA) or TO-92 Tape & Reel

Pin 管腳排列	Symbol 對應極性	Description 極性名詞	Description 極性含義	Plastic envelope Package		Marking 元件標識	Pin Polarity Circuit Diagram 腳位與極性 電路符號表示
				TO-92	TO-92編帶		
1	T1	Main terminal 1	第一陽極				
2	G	Gate	門-控制極				
3	T2	Main terminal 2	第二陽極				
4	---	---	---				
◇ 元件標識可按客戶指定要求 ◇ TO-92: 袋裝, 1000Pcs/包, 10Kpcs/盒, 100Kpcs/箱 ◇ TO-92編帶: 2Kpcs/盒, 50Kpcs/箱 ◇ 0.2g/Pcs, 每枚元件質量0.2克 ◇ 高壓規格機種、特殊觸發電流, 批量交期為6-8周						1=T1=MT1=第一陽極 2=G=門極 / 控制極 3=T2=MT2=第二陽極	

此規格SMD表面貼 SOT-89、SOT-223封裝同時生產, 需定制

ABSOLUTE MAXIMUM RATINGS

Parameter		Symbol	Value	Unit
Storage junction temperature range		T _{stg}	-40 to +150	°C
Operating junction temperature range		T _j	-40 to +125	
Repetitive Peak Off-state Voltage Repetitive Peak Reverse Voltage	HACT110-1000A HACT110-1200A T _j =25°C	V _{DRM} V _{RRM}	1000 1200	V
Non repetitive Surge Pake Off-state Voltage Non repetitive Pake Reverse Voltage	T _j =25°C	V _{DSM} V _{RSM}	V _{DRM} +100 V _{RRM} +100	
RMS on-state current (full sine wave)	T _c =57°C	I _{T(RMS)}	1	A
Non repetitive surge peak on-state current (One Full Cycle, Sine Wave, T _c =110°C)	tp=10ms	I _{TSM}	10	
	tp=8.3ms		11	
Peak gate current (tp=2μs, T _j =80°C)		I _{GM}	1	
I ² t Value for fusing (tp=10ms)		I ² t	1.12	A ² S
Average gate power dissipation (tp≤10ms, T _j =80°C)		P _{G(AV)}	0.2	W
Peak gate power dissipation (tp≤10ms, T _j =80°C)		P _{GM}	1	

ELECTRICAL CHARACTERISTICS (T_j=25°C unless otherwise specified)

Symbol	Test Condition	Quadrant		Ratings	Unit
I _{GT}	V _D =12V, R _L =30Ω	T2+ G+	MAX.	6	mA
		T2+ G-		10	
		T2- G-		10	
V _{GT}	V _D =12V, R _L =30Ω	ALL	MAX.	1.5	V
V _{GD}	V _D =V _{DRM} , R _L =3.3KΩ, T _j =125°C	ALL	MIN.	0.2	
I _L	I _G =1.2 I _{GT}	T2+ G+	MAX.	15	mA
		T2+ G-		25	
		T2- G-		10	
I _H	I _T =100mA		MAX.	10	
dV/dt	V _D =67%V _{DRM} gate open, T _j =125°C		MIN.	500	V/μS

STATIC CHARACTERISTICS

Symbol	Parameter		Value(MAX.)	Unit
V _{TM}	I _{TM} =1.4A, tp=380μS	T _j =25°C	1.6	V
I _{DRM} I _{RRM}	V _D =V _{DRM} , V _R =V _{RRM}	T _j =25°C	10	μA
		T _j =125°C	500	

THERMAL RESISTANCES

Symbol	Parameter		Value	Unit
R _{th(J-C)}	Junction to Case(AC)	TO-92	60	°C/W

支持綠色環保!
該產品已實行無鉛制程封裝
符合RoHS環保指令標準!



PACKAGE MECHANICAL DATA (mm)
TO-92 (TO-226AA) 直插封裝, 封裝尺寸 (單位:毫米)

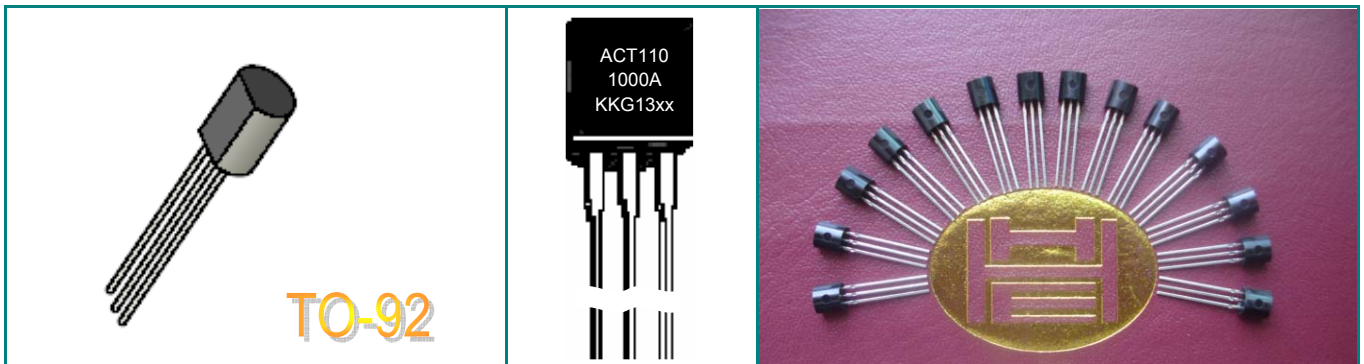

DIM	Inches 英寸單位		Millimeter 毫米單位	
	Min(最小)	Max(最大)	Min(最小)	Max(最大)
A	0.175	0.205	4.450	5.200
B	0.170	0.210	4.320	5.330
C	0.125	0.165	3.180	4.190
D	0.016	0.021	0.407	0.533
G	0.045	0.055	1.150	1.390
H	0.095	0.105	2.420	2.660
J	0.015	0.020	0.390	0.500
K	0.500	-----	12.70	----
L	0.250	-----	6.350	----
N	0.080	0.105	2.040	2.660
P	-----	0.100	----	2.540
R	0.115	----	2.930	----
V	0.135	----	3.430	----

TO-92
or
TO-226
封裝尺寸

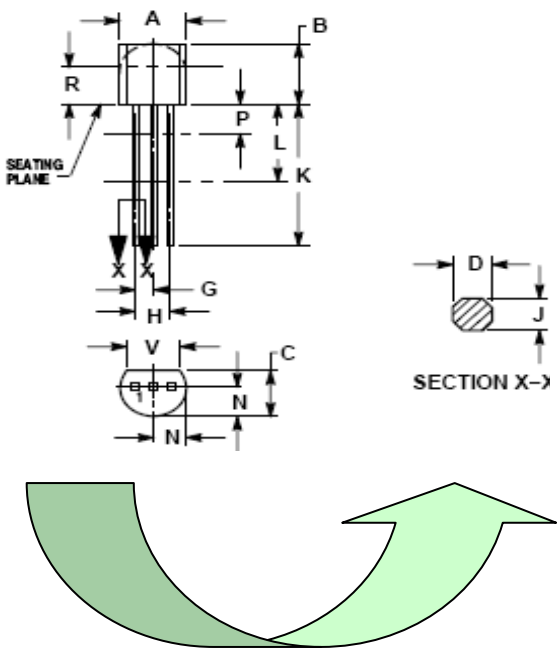

PACKAGE MECHANICAL DATA (mm): TO-92 Tape & Reel 成型腳位編帶封裝尺寸 (單位:毫米)

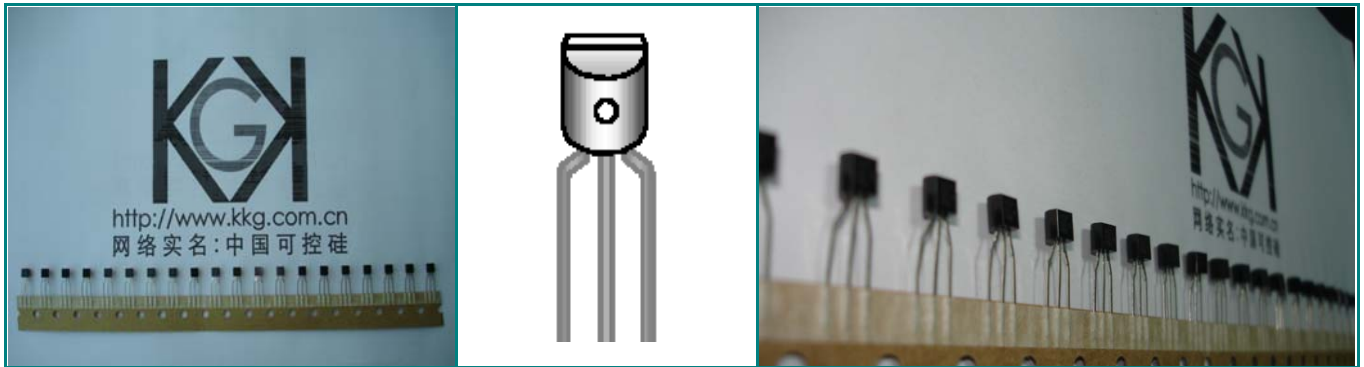

TO-92
Tape & Reel
TO-92
成型腳位
編帶封裝
封裝尺寸

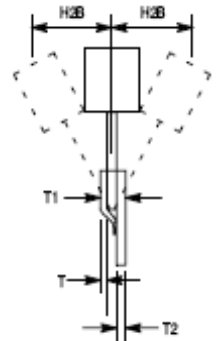
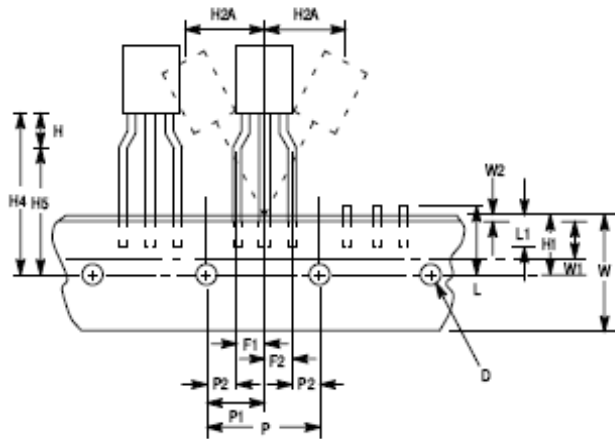

SYMBOL 符號表示	Item 項目詳述	Inches (英寸單位)		Millimeter (毫米單位)	
		Min (最小)	Max (最大)	Min (最小)	Max (最大)
D	Tape Feedhole Diameter	0.1496	0.1653	3.8	4.2
D2	Component Lead Thickness Dimension	0.015	0.020	0.380	0.510
F1, F2	Component Lead Pitch	0.945	0.11	2.4	2.8
H	Bottom of Component to Seating Plane	0.059	0.156	1.5	4
H1	Feedhole Location	0.3346	0.3741	8.5	9.5
H2A	Deflection Left or Right	0	0.039	0	1
H2B	Deflection Front or Rear	0	0.051	0	1
H4	Feedhole to Bottom of Component	0.7086	0.768	18	19.5
H5	Feedhole to Seating Plane	0.61	0.649	15.5	16.5
L	Defective Unit Clipped Dimension	0.3346	0.433	8.5	11
L1	Lead Wire Enclosure	0.09842	---	2.5	---
P	Feedhole Pitch	0.4921	0.5079	12.5	12.9
P1	Feedhole Center to Center Lead	0.2342	0.2658	5.95	6.75
P2	First Lead Spacing Dimension	0.1397	0.1556	3.55	3.95
T	Adhesive Tape Thickness	0.06	0.08	0.15	0.200
T1	Overall Taped Package Thickness	---	0.0567	---	1.440
T2	Carrier Strip Thickness	0.014	0.027	0.350	0.650
W	Carrier Strip Width	0.6889	0.7481	17.50	19.00
W1	Adhesive Tape Width	0.2165	0.2841	5.50	6.30
W2	Adhesive Tape Position	0.0059	0.01968	0.15	0.50

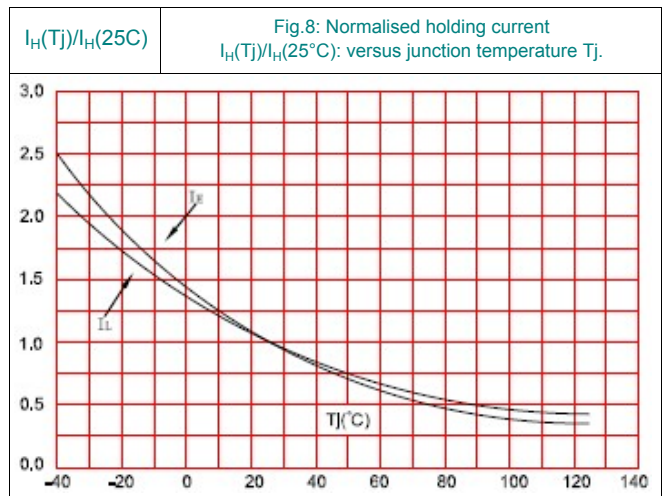
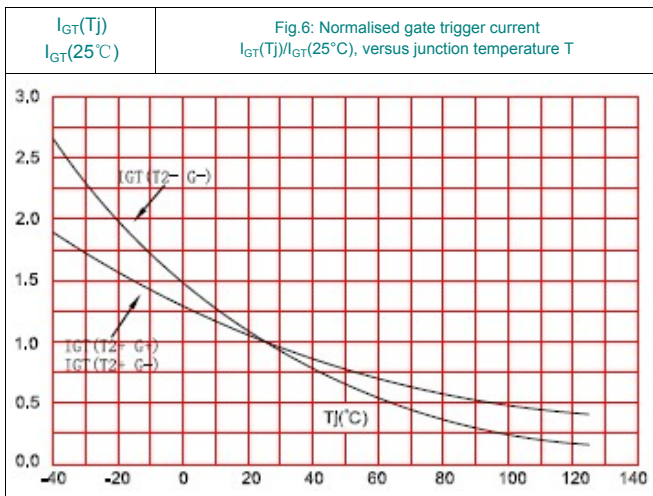
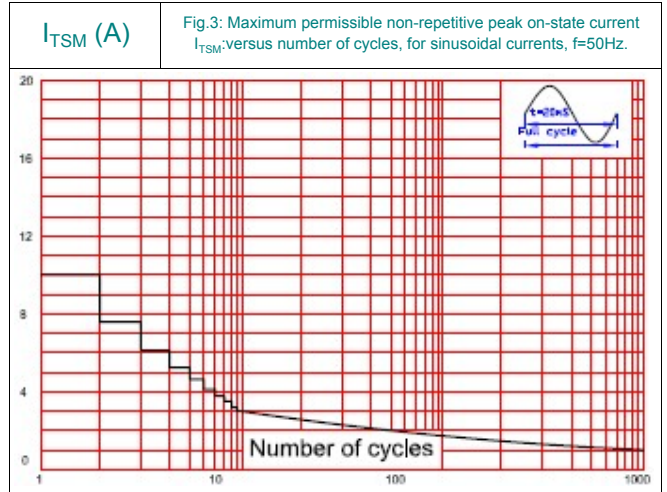
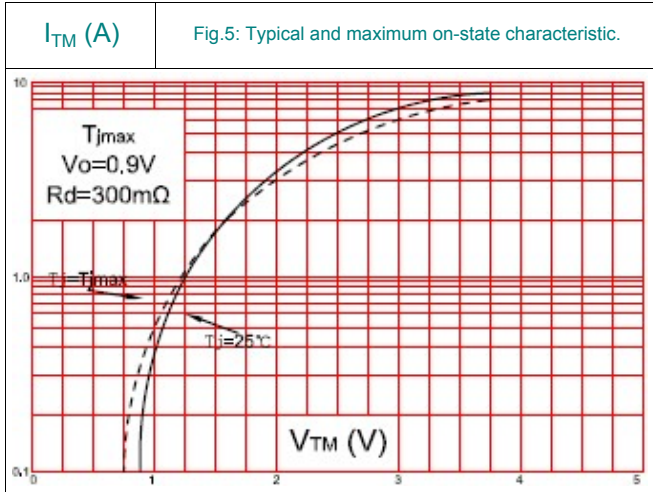
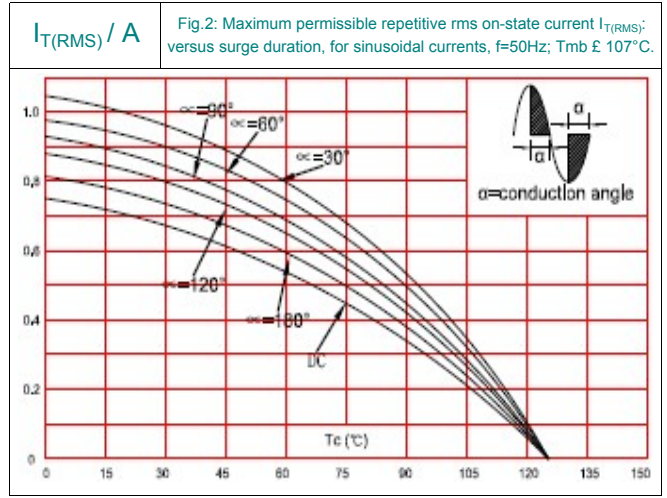
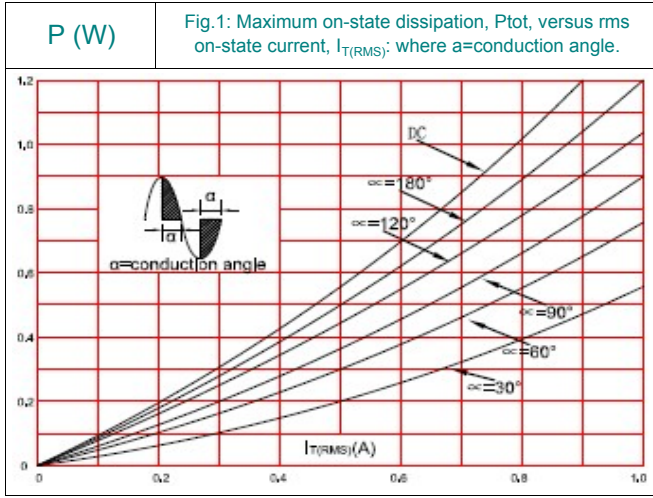



经中华人民共和国工商行政管理总局商标局批准
KKG 图案、字母、均为我公司正式注册商标，仿冒、盗用均属侵权，违法必究！

深圳市浩海电子有限公司 SHENZHEN HAOHAI ELECTRONICS CO., LTD.

ADD: Room A502-503, 5th Floor, Block A, Huafeng Commercial Building,
Area 25, Bao'an District, Shenzhen, Guangdong Province, CHINA.

中国.广东省.深圳市.宝安区.宝城25区.华丰商务大厦A座五楼A502~503

公司电话 TEL: +86-755-29955080、29955081、29955082、29955083
总机八线 29955090、29955091、29955092、29955093

FAX: +86-755-27801767, 27858737

Web: <http://www.kkg.com.cn>

E-mail: kkg@kkg.com.cn