



## G5系列

安装孔位、操作柄类型、接触形式、外形介绍、端子类  
Mounting Hole, Lever Type, Contact, Shape, Terminal Style

### 内部构造图/Inner Construction

普通型 For General Type	G5S05/G5T10 For G5S05/G5T10	触点间距>3mm For Contact Gap>3mm
1.操作柄/Lever 2.按挚/Plunger 3.胶盖/Cover	4.支杆/Internal Lever 5.公共端子/Common Terminal 6.触点/Contacts	7.NC/NO端子/NO/NC Terminals 8.胶座/Case 9.动片/Movable Plate 10.弹片/弹簧(右图) Spring

### 外形特征/Outline Characteristics

基本形/Basic Type 配端子:C,D,E,L,R... Optional Terminal	平端形/Flat Type 配端子:C1,D1,E1,L1,R1... Optional Terminal	完全平端形/Fully Flat Type 配端子:C2,D2,E2,L2,R2... Optional Terminal

### 安装孔尺寸/Mounting Hole Dimensions

(单位/Measure:mm)

基本形 Basic Type	K形 K Type	左侧面PCB端子 Left Side PCB Terminal	右侧面PCB端子 Right Side PCB Termin

### 接触形式图/Contact Configuration

公共端类型/Common Terminal Typeal	"Z"转换式SPDT	"C"常闭式SPST-NC	"P"常开式SPST-NO
公共端在底部 Bottom Common Terminal			

## 接线端子尺寸/Connect Terminal Dimensions

### 基本型胶壳/Terminals for Basic Type Case/Cover

(单位/Measure:mm)

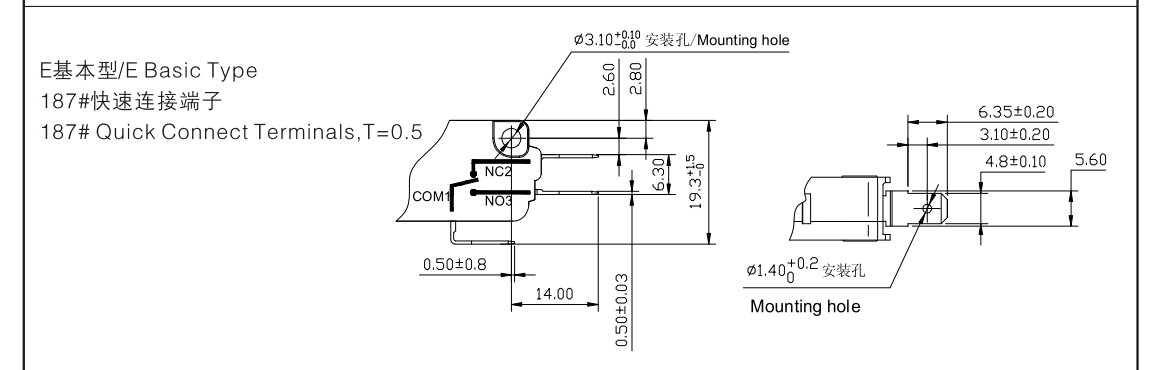
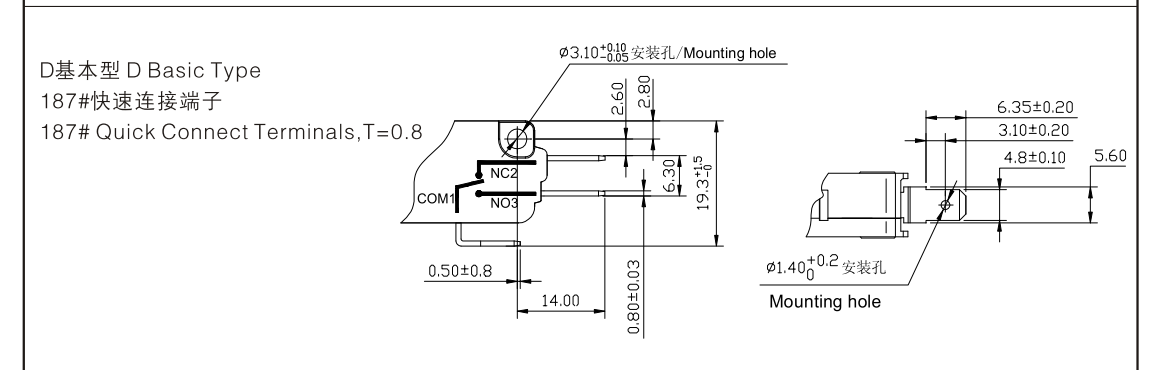
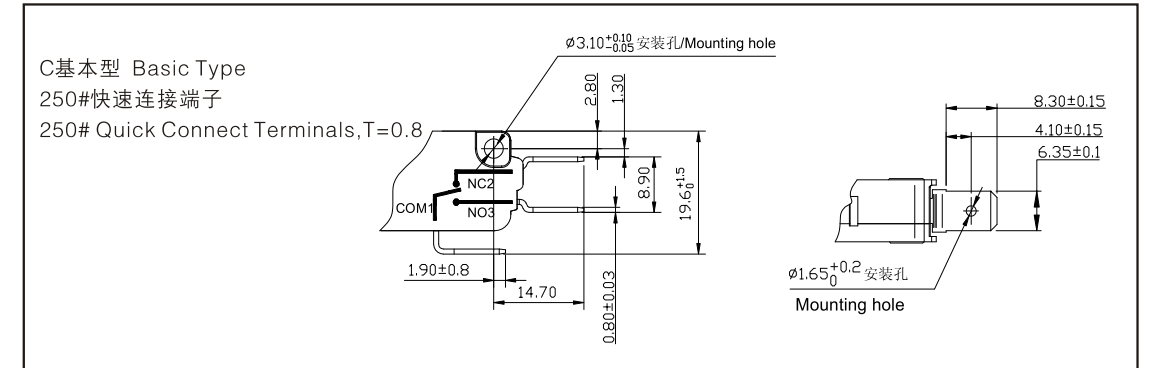

### 平端型胶壳/Terminals for Flat Type Case/Cover

(单位/Measure:mm)

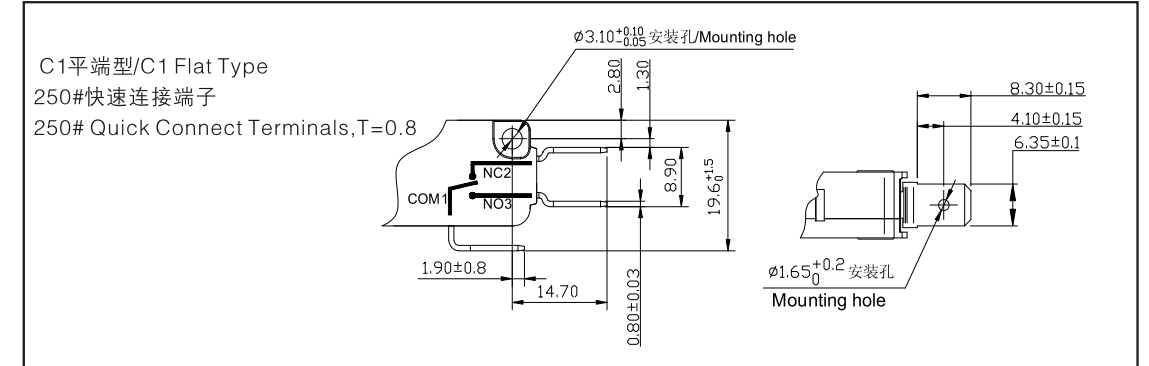

(单位/Measure:mm)

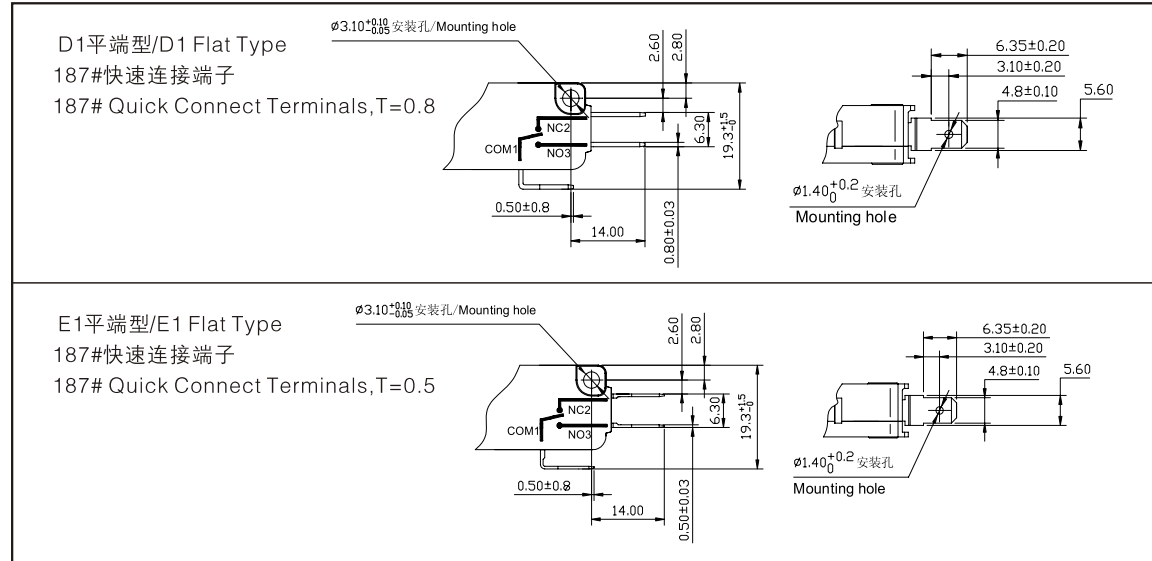

◆ 完全平端型胶壳/Terminals for Fully Flat Type Case/Cover

(单位/Measure:mm)

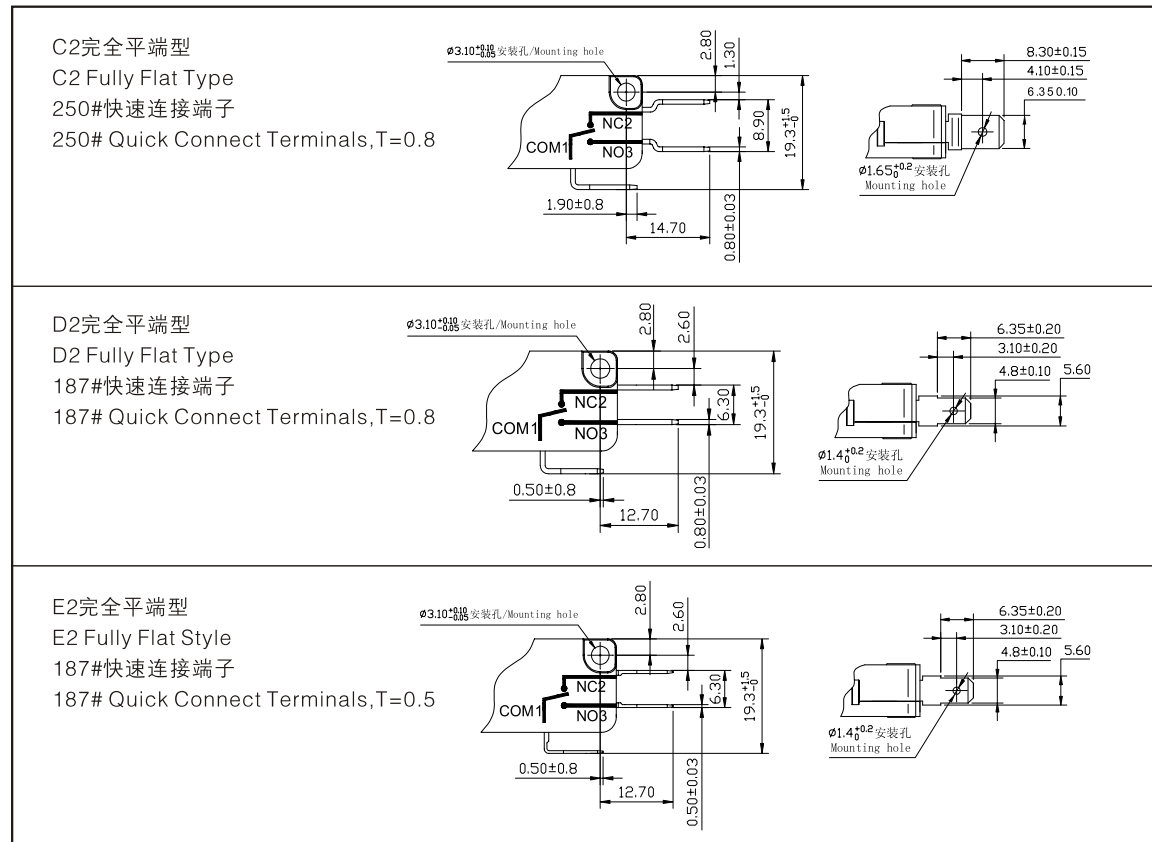

◆ 其他端子类型/Other Terminals

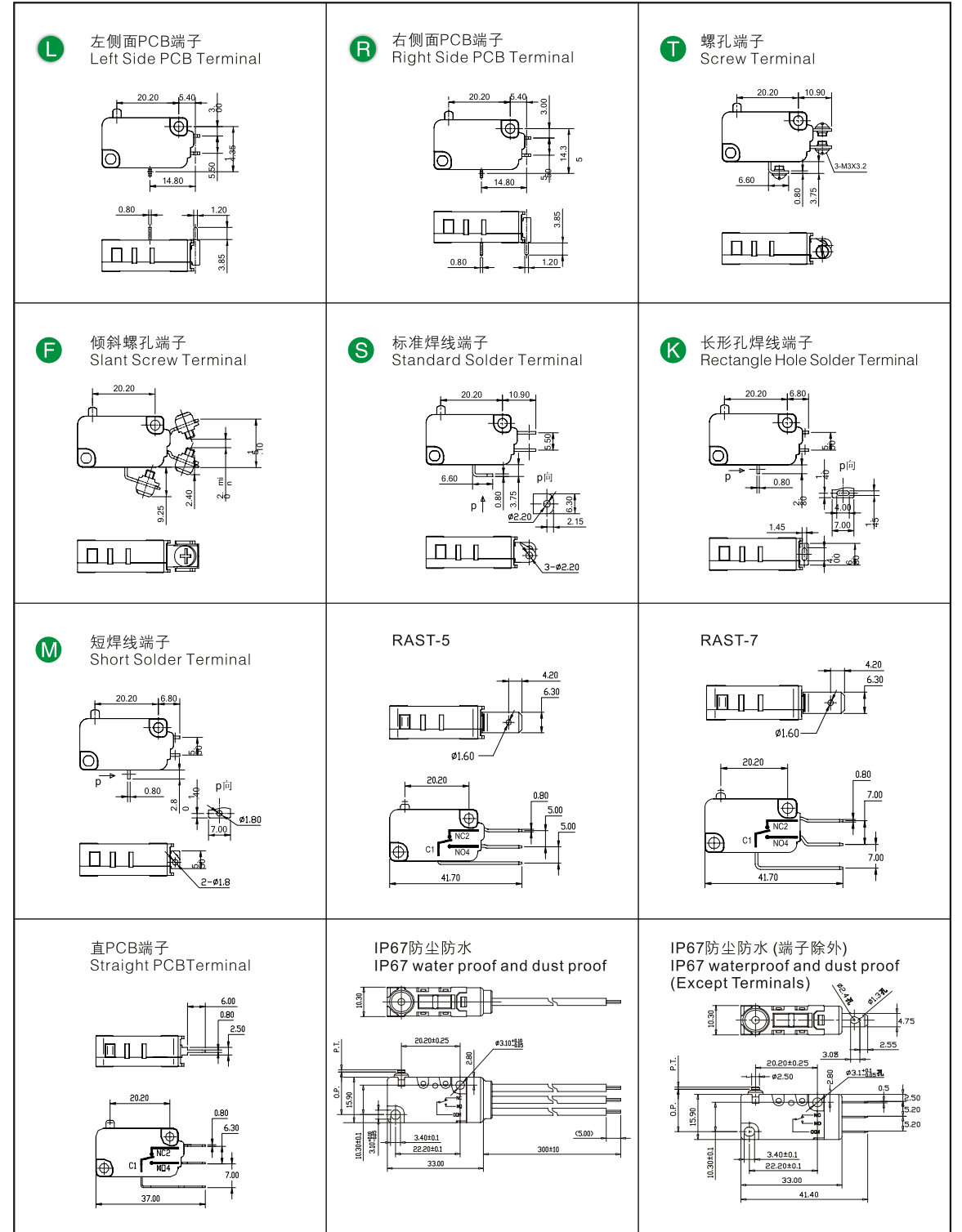

## ◆ 其他手柄类型/Other Levers

<p>#08手柄 Lever #08</p>	<p>#32手柄 Lever #32</p>
<p>#09手柄 Lever #09</p>	<p>#45手柄 Lever #45</p>
<p>#23手柄 Lever #23</p>	<p>#46手柄 Lever #46</p>
<p>#24手柄 Lever #24</p>	

## ◆ 外形尺寸和操作特性 Dimensions and Operating Characteristics

(单位/Measure:mm)

### ◆ 柱式按挚 Pin Plunger

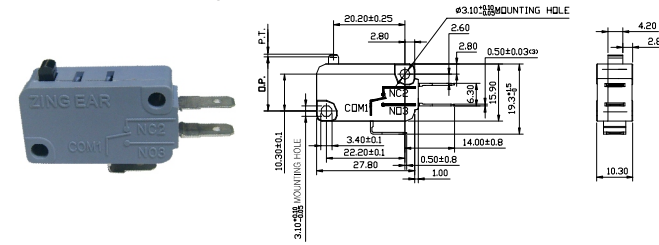

型号 Part Number	操作参数/Parameters							
	OF	RF	PT	OT	MD	OP		
	Max.	Min.	Max.	Min.	Max.	Min.		
G5□□□-E1Z015	0.15	15	0.03	3	1.6	0.8	0.4	14.7±0.5
G5□□□-E1Z025	0.25	25	0.05	5	1.6	0.8	0.4	14.7±0.5
G5□□□-E1Z050	0.49	50	0.10	10	1.6	0.8	0.4	14.7±0.5
G5□□□-E1Z100	0.98	100	0.25	25	1.6	0.8	0.4	14.7±0.5
G5□□□-E1Z200	1.96	200	0.49	50	1.6	0.8	0.4	14.7±0.5
G5□□□-E1Z300	2.94	300	0.74	75	1.6	0.8	0.4	14.7±0.5
G5□□□-E1Z400	3.92	400	0.98	100	1.6	0.8	0.4	14.7±0.5

### ◆ 短直柄 Short Straight Lever

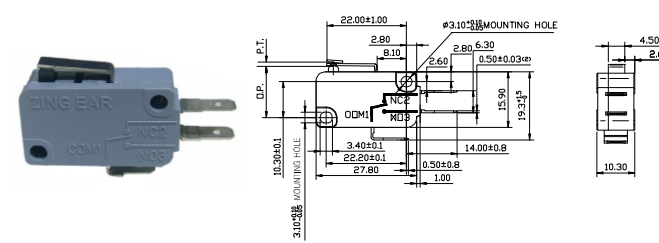

型号 Part Number	操作参数/Parameters							
	OF	RF	PT	OT	MD	OP		
	Max.	Min.	Max.	Min.	Max.	Min.		
G5□□□-E1Z015A01	0.15	15	0.03	3	1.6	0.8	0.4	15.3±0.5
G5□□□-E1Z025A01	0.25	25	0.05	5	1.6	0.8	0.4	15.3±0.5
G5□□□-E1Z050A01	0.49	50	0.10	10	1.6	0.8	0.4	15.3±0.5
G5□□□-E1Z100A01	0.98	100	0.25	25	1.6	0.8	0.4	15.3±0.5
G5□□□-E1Z200A01	1.96	200	0.49	50	1.6	0.8	0.4	15.3±0.5
G5□□□-E1Z300A01	2.94	300	0.74	75	1.6	0.8	0.4	15.3±0.5
G5□□□-E1Z400A01	3.92	400	0.98	100	1.6	0.8	0.4	15.3±0.5

### ◆ 标准直柄 Standard Straight Lever

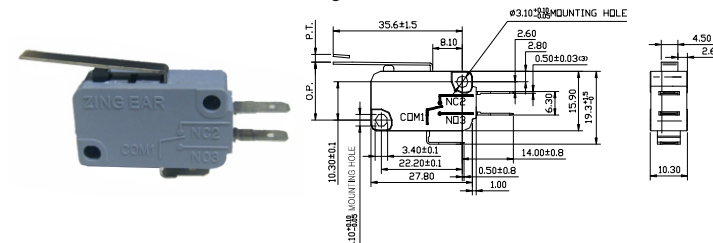

型号 Part Number	操作参数/Parameters							
	OF	RF	PT	OT	MD	OP		
	Max.	Min.	Max.	Min.	Max.	Min.		
G5□□□-E1Z015A02	0.10	10	0.02	2	3.2	1.3	1.2	15.3±1.5
G5□□□-E1Z025A02	0.15	15	0.02	2	3.2	1.3	1.2	15.3±1.5
G5□□□-E1Z050A02	0.29	30	0.05	5	3.2	1.3	1.2	15.3±1.5
G5□□□-E1Z100A02	0.59	60	0.10	10	3.2	1.3	1.2	15.3±1.5
G5□□□-E1Z200A02	1.18	120	0.20	20	3.2	1.3	1.2	15.3±1.5
G5□□□-E1Z300A02	1.77	180	0.29	30	3.2	1.3	1.2	15.3±1.5
G5□□□-E1Z400A02	2.35	240	0.39	40	3.2	1.3	1.2	15.3±1.5

### ◆ 长直柄 Long Straight Lever

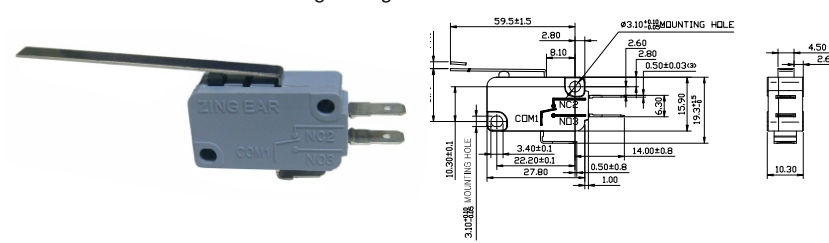

型号 Part Number	操作参数/Parameters							
	OF	RF	PT	OT	MD	OP		
	Max.	Min.	Max.	Min.	Max.	Min.		
G5□□□-E1Z015A03	0.07	7	0.02	2	6.4	2.6	2.4	15.3±3
G5□□□-E1Z025A03	0.10	10	0.02	2	6.4	2.6	2.4	15.3±3
G5□□□-E1Z050A03	0.15	15	0.02	2	6.4	2.6	2.4	15.3±3
G5□□□-E1Z100A03	0.29	30	0.05	5	6.4	2.6	2.4	15.3±3
G5□□□-E1Z200A03	0.59	60	0.10	10	6.4	2.6	2.4	15.3±3
G5□□□-E1Z300A03	0.88	90	0.15	15	6.4	2.6	2.4	15.3±3
G5□□□-E1Z400A03	1.18	120	0.20	20	6.4	2.6	2.4	15.3±3

### ◆ 模拟滚轮手柄 Simulated Roller Lever

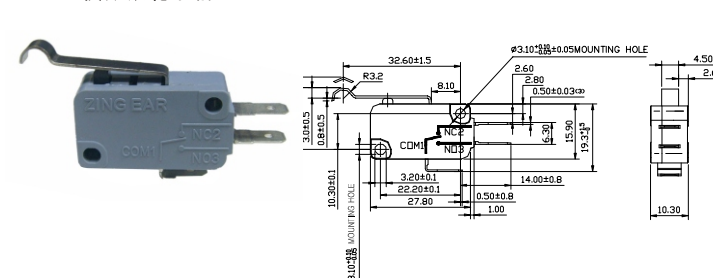

型号 Part Number	操作参数/Parameters							
	OF	RF	PT	OT	MD	OP		
	Max.	Min.	Max.	Min.	Max.	Min.		
G5□□□-E1Z015A04	0.10	10	0.02	2	3.2	1.3	1.2	18.3±1.5
G5□□□-E1Z025A04	0.15	15	0.02	2	3.2	1.3	1.2	18.3±1.5
G5□□□-E1Z050A04	0.29	30	0.02	2	3.2	1.3	1.2	18.3±1.5
G5□□□-E1Z100A04	0.59	60	0.10	10	3.2	1.3	1.2	18.3±1.5
G5□□□-E1Z200A04	1.18	120	0.20	20	3.2	1.3	1.2	18.3±1.5
G5□□□-E1Z300A04	1.77	180	0.30	30	3.2	1.3	1.2	18.3±1.5
G5□□□-E1Z400A04	2.35	240	0.39	40	3.2	1.3	1.2	18.3±1.5

### ◆短滚轮手柄 Short Roller Lever

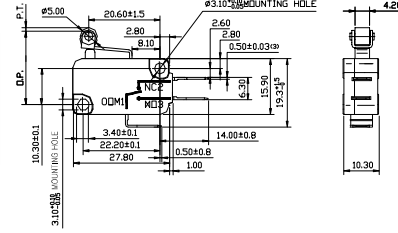

型号 Part Number	操作参数/Parameters						OP (mm)	
	OF Max.	RF Min.	PT Max.	OT Min.	MD Max.	OP (mm)		
	(N)	(gf)	(N)	(gf)	(mm)			
G5□□□-E1Z015A05	0.15	15	0.03	3	1.6	0.8	0.4	20.6±0.8
G5□□□-E1Z025A05	0.30	30	0.05	5	1.6	0.8	0.4	20.6±0.8
G5□□□-E1Z050A05	0.59	60	0.10	10	1.6	0.8	0.4	20.6±0.8
G5□□□-E1Z100A05	1.18	120	0.20	20	1.6	0.8	0.4	20.6±0.8
G5□□□-E1Z200A05	2.35	240	0.39	40	1.6	0.8	0.4	20.6±0.8
G5□□□-E1Z300A05	3.43	350	0.59	60	1.6	0.8	0.4	20.6±0.8
G5□□□-E1Z400A05	4.60	470	0.78	80	1.6	0.8	0.4	20.6±0.8

### ◆长滚轮手柄 Long Roller Lever

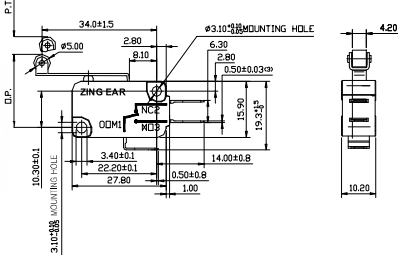

型号 Part Number	操作参数/Parameters						OP (mm)	
	OF Max.	RF Min.	PT Max.	OT Min.	MD Max.	OP (mm)		
	(N)	(gf)	(N)	(gf)	(mm)			
G5□□□-E1Z015A06	0.10	10	0.02	2	3.2	1.3	1.2	20.6±1.6
G5□□□-E1Z025A06	0.15	15	0.02	2	3.2	1.3	1.2	20.6±1.6
G5□□□-E1Z050A06	0.29	30	0.05	5	3.2	1.3	1.2	20.6±1.6
G5□□□-E1Z100A06	0.59	60	0.10	10	3.2	1.3	1.2	20.6±1.6
G5□□□-E1Z200A06	1.18	120	0.20	20	3.2	1.3	1.2	20.6±1.6
G5□□□-E1Z300A06	1.77	180	0.29	30	3.2	1.3	1.2	20.6±1.6
G5□□□-E1Z400A06	2.35	240	0.39	40	3.2	1.3	1.2	20.6±1.6

### ◆柱式按挚250#端子 Pin Plunger 250# Terminal

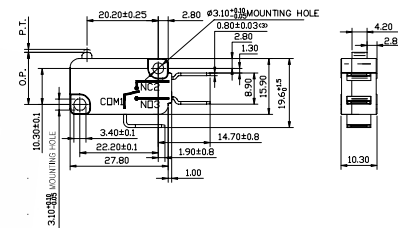

型号 Part Number	操作参数/Parameters						OP (mm)	
	OF Max.	RF Min.	PT Max.	OT Min.	MD Max.	OP (mm)		
	(N)	(gf)	(N)	(gf)	(mm)			
G5□□□-C1Z015	0.15	15	0.03	3	1.6	0.8	0.4	14.7±0.5
G5□□□-C1Z025	0.25	25	0.05	5	1.6	0.8	0.4	14.7±0.5
G5□□□-C1Z050	0.49	50	0.10	10	1.6	0.8	0.4	14.7±0.5
G5□□□-C1Z100	0.98	100	0.25	25	1.6	0.8	0.4	14.7±0.5
G5□□□-C1Z200	1.96	200	0.49	50	1.6	0.8	0.4	14.7±0.5
G5□□□-C1Z300	2.94	300	0.74	75	1.6	0.8	0.4	14.7±0.5
G5□□□-C1Z400	3.92	400	0.98	100	1.6	0.8	0.4	14.7±0.5

### ◆柱式按挚带头壳体250#端子 Pin Plunger Basic Case/Cover 250# Terminal

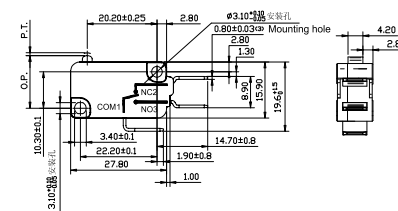

型号 Part Number	操作参数/Parameters						OP (mm)	
	OF Max.	RF Min.	PT Max.	OT Min.	MD Max.	OP (mm)		
	(N)	(gf)	(N)	(gf)	(mm)			
G5□□□-CZ015	0.15	15	0.03	3	1.6	0.8	0.4	14.7±0.5
G5□□□-CZ025	0.25	25	0.05	5	1.6	0.8	0.4	14.7±0.5
G5□□□-CZ050	0.49	50	0.10	10	1.6	0.8	0.4	14.7±0.5
G5□□□-CZ100	0.98	100	0.25	25	1.6	0.8	0.4	14.7±0.5
G5□□□-CZ200	1.96	200	0.49	50	1.6	0.8	0.4	14.7±0.5
G5□□□-CZ300	2.94	300	0.74	75	1.6	0.8	0.4	14.7±0.5
G5□□□-CZ400	3.92	400	0.98	100	1.6	0.8	0.4	14.7±0.5

### ◆柱式按挚带头壳体187#端子 Pin Plunger Basic Case/Cover 187# Terminal

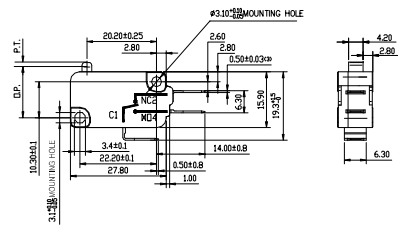

型号 Part Number	操作参数/Parameters						OP (mm)	
	OF Max.	RF Min.	PT Max.	OT Min.	MD Max.	OP (mm)		
	(N)	(gf)	(N)	(gf)	(mm)			
G5□□□-EZ015	0.15	15	0.03	3	1.6	0.8	0.4	14.7±0.5
G5□□□-EZ025	0.25	25	0.05	5	1.6	0.8	0.4	14.7±0.5
G5□□□-EZ050	0.49	50	0.10	10	1.6	0.8	0.4	14.7±0.5
G5□□□-EZ100	0.98	100	0.25	25	1.6	0.8	0.4	14.7±0.5
G5□□□-EZ200	1.96	200	0.49	50	1.6	0.8	0.4	14.7±0.5
G5□□□-EZ300	2.94	300	0.74	75	1.6	0.8	0.4	14.7±0.5
G5□□□-EZ400	3.92	400	0.98	100	1.6	0.8	0.4	14.7±0.5

## G5系列 Series-G5W

### 密封型防水防尘微动开关 Sealed Micro Switch



#### ■特点/Features

- ◆防水防尘设计,可以在会淋水或多尘埃的地方使用.
- ◆结构紧凑,具有微小触点间隙,快速动作、高灵敏度和微小动作行程的特点
- ◆长寿命,高精度、高可靠性,安装和G5系列相同.
- ◆可在汽车、农业机械、大型家电、办公设备等有耐环境性要求的场合使用

- Water proof and dust proof
- Tight structure、small contact gap snap action、high sensitivity
- Long life,high precision and reliability
- Widely used in Auto、agricultural equipment、applications,office equipment etc

#### ■应用/Application

- ◆家用电器
- ◆电子设备
- ◆自动化设备
- ◆汽车电子
- ◆农业机械
- ◆办公设备

- Home Appliances
- Electrical devices
- Automatic equipments
- Auto Electronic
- Agricultural equipments
- Office equipments

#### ■特性参数/Parameters:

额定值Rating	W1	ENEC 0.1A 48VDC, 0.1A 125/250VAC, 40T85, 5E4, u UL 0.1A 48VDC, 0.1A 125/250VAC, T85
	W2	ENEC: 5A 125/250VAC, 5A, 30VDC, 40T85, 5E4, u UL: 5A 125/250VAC, 5A 30VDC T85
	W3	ENEC 10(2)A 125/250VAC, 0.5A 125VDC, 0.25A 250VDC, 40T85, u, 2E4 UL 10.1A 1/10HP 125/250VAC, 0.5A 125VDC, 0.25A 250VDC, T85
容许操作频率 Operating Frequency	电气Electrical	10~30次/分 times/min
	机械Mechanical	60次/分 times/min
接触电阻 (初始值) Contact Resistance (initial value)	端子型with terminal	最大50mΩ; 50mΩ Max
	导线型with wire	最大100mΩ; 100mΩ Max (取决于导线的长短/Depends on the length of the wire)
绝缘电阻Insulation resistance	在500VDC 时/at 500VDC, 100MΩ Min.	
抗电强度Dielectric Strength	同极端子间 Between terminals	AC 1000V 50~60Hz 1min
	端子外壳间 Between terminals and housing	AC 1500V 50~60Hz 1min
保存温度Storage Temperature	-40° C ~ +85° C	
保存湿度Storage Humidity	85%RH Max	
保护结构Protection grade	端子型 With terminal	IEC IP67 (端子部除外 Terminal not included)
	导线型 With wire	IEC IP67
防触电保护级Electric-shock safeguard grade	Class II	
PTI (漏电流特性)	250	
寿命Life	电气E-life	2万次 ~ 10万次以上 (取决于类型) 2E4 ~ 10E4 cycles (depends on P/Ns)
	机械M-life	100万次以上 (60次/分 Times/min) ; over 1,000,000 cycles (60 cycles/min)
重量Weight	约7g (端子型、不带手柄) Approx. 7g (with terminal and without lever)	

#### ■订货指引 Ordering Instruction

参见第十二页/ Refer to Page 12

## ◆外形尺寸和操作特性 Dimensions and Operating Characteristics

(单位/Measure:mm)

### ◆G5W11-E□□-W□



型号 Part Number	操作参数/Parameters							
	OF Max.		RF Min.		PT Max.	OT Min.	MD Max.	OP
	(N)	(gf)	(N)	(gf)	(mm)	(mm)	(mm)	(mm)
G5W11-EZ015-W□	0.30	30	0.05	5	1.6	0.8	0.4	14.7±0.5
G5W11-EZ025-W□	0.40	40	0.10	10	1.6	0.8	0.4	14.7±0.5
G5W11-EZ050-W□	0.64	65	0.15	15	1.6	0.8	0.4	14.7±0.5
G5W11-EZ100-W□	1.08	110	0.35	35	1.6	0.8	0.4	14.7±0.5
G5W11-EZ200-W□	2.06	210	0.60	60	1.6	0.8	0.4	14.7±0.5

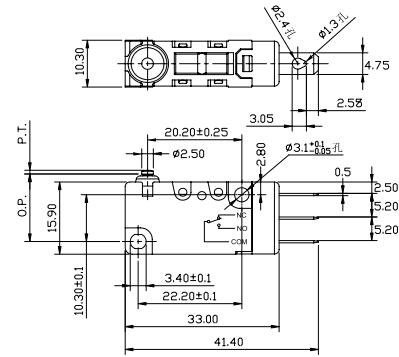

### ◆G5W11-W□□-W□

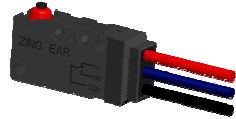

型号 Part Number	操作参数/Parameters							
	OF Max.		RF Min.		PT Max.	OT Min.	MD Max.	OP
	(N)	(gf)	(N)	(gf)	(mm)	(mm)	(mm)	(mm)
G5W11-WZ015-W□	0.30	30	0.05	5	1.6	0.8	0.4	14.7±0.5
G5W11-WZ025-W□	0.40	40	0.10	10	1.6	0.8	0.4	14.7±0.5
G5W11-WZ050-W□	0.64	65	0.15	15	1.6	0.8	0.4	14.7±0.5
G5W11-WZ100-W□	1.08	110	0.35	35	1.6	0.8	0.4	14.7±0.5
G5W11-WZ200-W□	2.06	210	0.60	60	1.6	0.8	0.4	14.7±0.5

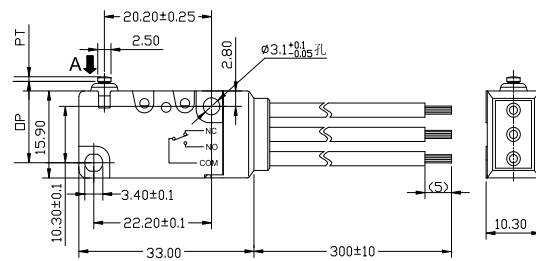

### ◆G5W11-W□□A01-W□

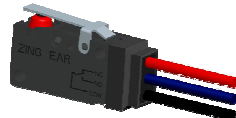

型号 Part Number	操作参数/Parameters							
	OF Max.		RF Min.		PT Max.	OT Min.	MD Max.	OP
	(N)	(gf)	(N)	(gf)	(mm)	(mm)	(mm)	(mm)
G5W11-WZ015A01-W□	0.30	30	0.05	5	1.6	0.8	0.4	15.3±0.5
G5W11-WZ025A01-W□	0.40	40	0.10	10	1.6	0.8	0.4	15.3±0.5
G5W11-WZ050A01-W□	0.64	65	0.15	15	1.6	0.8	0.4	15.3±0.5
G5W11-WZ100A01-W□	1.08	110	0.35	35	1.6	0.8	0.4	15.3±0.5
G5W11-WZ200A01-W□	2.06	210	0.59	60	1.6	0.8	0.4	15.3±0.5

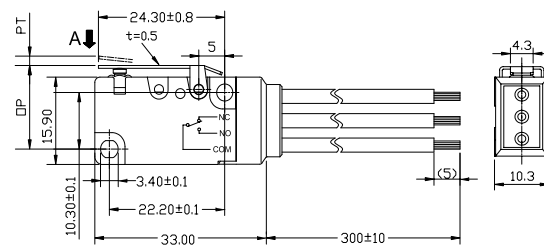

### ◆G5W11-W□□A02-W□



型号 Part Number	操作参数/Parameters							
	OF Max.		RF Min.		PT Max.	OT Min.	MD Max.	OP
	(N)	(gf)	(N)	(gf)	(mm)	(mm)	(mm)	(mm)
G5W11-WZ015A02-W□	0.20	20	0.05	5	3.2	1.3	1.2	15.3±1.5
G5W11-WZ025A02-W□	0.25	25	0.08	8	3.2	1.3	1.2	15.3±1.5
G5W11-WZ050A02-W□	0.40	40	0.15	15	3.2	1.3	1.2	15.3±1.5
G5W11-WZ100A02-W□	0.64	65	0.25	25	3.2	1.3	1.2	15.3±1.5
G5W11-WZ200A02-W□	1.27	130	0.35	35	3.2	1.3	1.2	15.3±1.5

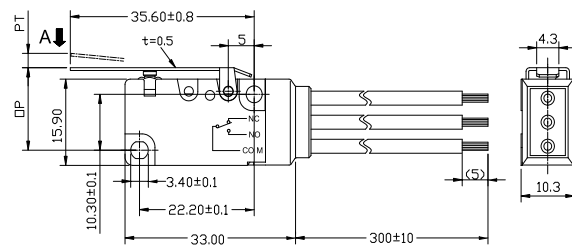

### ◆G5W11-W□□A03-W□



型号 Part Number	操作参数/Parameters							
	OF Max.		RF Min.		PT Max.	OT Min.	MD Max.	OP
	(N)	(gf)	(N)	(gf)	(mm)	(mm)	(mm)	(mm)
G5W11-WZ015A03-W□	0.10	10	0.03	3	6.4	2.6	2.4	15.3±3
G5W11-WZ025A03-W□	0.15	15	0.05	5	6.4	2.6	2.4	15.3±3
G5W11-WZ050A03-W□	0.20	20	0.08	8	6.4	2.6	2.4	15.3±3
G5W11-WZ100A03-W□	0.35	35	0.10	10	6.4	2.6	2.4	15.3±3
G5W11-WZ200A03-W□	0.64	65	0.15	15	6.4	2.6	2.4	15.3±3

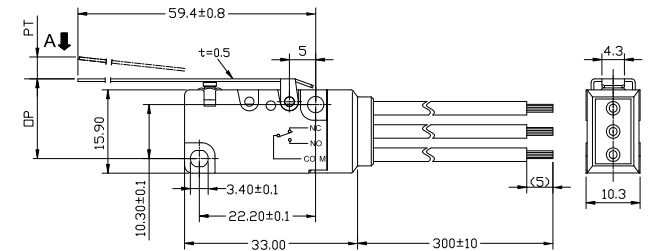

### ◆G5W11-W□□A04-W□

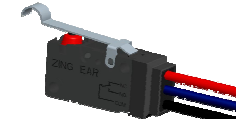

型号 Part Number	操作参数/Parameters							
	OF Max.		RF Min.		PT Max.	OT Min.	MD Max.	OP
	(N)	(gf)	(N)	(gf)	(mm)	(mm)	(mm)	(mm)
G5W11-WZ015A04-W□	0.20	20	0.05	5	3.2	1.3	1.2	18.5±1.5
G5W11-WZ025A04-W□	0.25	25	0.08	8	3.2	1.3	1.2	18.5±1.5
G5W11-WZ050A04-W□	0.40	40	0.15	15	3.2	1.3	1.2	18.5±1.5
G5W11-WZ100A04-W□	0.64	65	0.25	25	3.2	1.3	1.2	18.5±1.5
G5W11-WZ200A04-W□	1.27	130	0.35	35	3.2	1.3	1.2	18.5±1.5

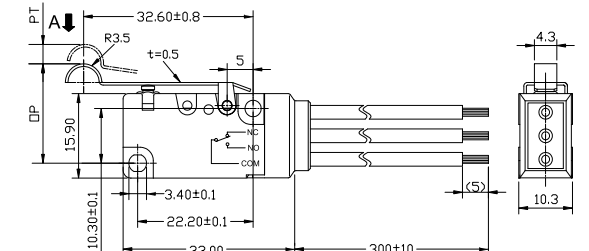

### ◆G5W11-W□□A05-W□

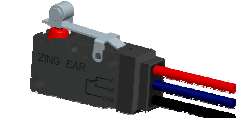

型号 Part Number	操作参数/Parameters							
	OF Max.		RF Min.		PT Max.	OT Min.	MD Max.	OP
	(N)	(gf)	(N)	(gf)	(mm)	(mm)	(mm)	(mm)
G5W11-WZ015A05-W□	0.30	30	0.05	5	1.6	0.8	0.4	20.6±0.8
G5W11-WZ025A05-W□	0.40	40	0.10	10	1.6	0.8	0.4	20.6±0.8
G5W11-WZ050A05-W□	0.64	65	0.15	15	1.6	0.8	0.4	20.6±0.8
G5W11-WZ100A05-W□	1.18	120	0.35	35	1.6	0.8	0.4	20.6±0.8
G5W11-WZ200A05-W□	2.35	240	0.59	60	1.6	0.8	0.4	20.6±0.8

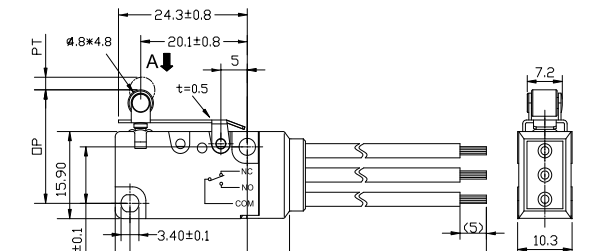

### ◆G5W11-W□□A06-W□

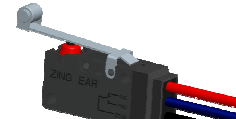

型号 Part Number	操作参数/Parameters							
	OF Max.		RF Min.		PT Max.	OT Min.	MD Max.	OP
	(N)	(gf)	(N)	(gf)	(mm)	(mm)	(mm)	(mm)
G5W11-WZ015A06-W□	0.20	20	0.05	5	3.2	1.3	1.2	20.6±1.6
G5W11-WZ025A06-W□	0.25	25	0.08	8	3.2	1.3	1.2	20.6±1.6
G5W11-WZ050A06-W□	0.40	40	0.15	15	3.2	1.3	1.2	20.6±1.6
G5W11-WZ100A06-W□	0.64	65	0.25	25	3.2	1.3	1.2	20.6±1.6
G5W11-WZ200A06-W□	1.27	130	0.35	35	3.2	1.3	1.2	20.6±1.6

