

# POH3316P



## ◆ 特征 Feature

- 具有高性能，低价格。  
Designed for lowest cost and high performance.
- 具备高能量存储和低直流电阻。  
High energy storage and very low resistance.
- 有较高的电感值，尤其适用于 EL 板驱动电路。  
Higher L values are suitable for EL driver circuits.

型号 Part number	电感量 Inductance	直流电阻 DCR	自谐频率 SRF	饱和电流 Isat	温升电流 I <sub>rms</sub>
Units	(μH)	(Ω) max	(MHz) typ	(A) 30% drop	(A) 40°C rise
POH3316P-1R0ML	1.0±20%	0.009	100	9.0	6.8
POH3316P-1R5ML_	1.5±20%	0.010	90	8.0	6.4
POH3316P-2R2ML_	2.2±20%	0.012	80	7.0	6.1
POH3316P-3R3ML_	3.3±20%	0.015	65	6.4	5.4
POH3316P-4R7ML_	4.7±20%	0.018	45	5.4	4.8
POH3316P-6R8ML_	6.8±20%	0.027	38	4.6	4.4
POH3316P-100ML_	10±20%	0.038	30	3.8	3.9
POH3316P-150ML_	15±20%	0.046	27	3.0	3.1
POH3316P-220ML_	22±20%	0.085	19	2.3	2.7
POH3316P-330ML_	33±20%	0.10	15	2.0	2.1
POH3316P-470ML_	47±20%	0.14	12	1.6	1.8
POH3316P-680ML_	68±20%	0.20	10	1.4	1.5
POH3316P-101KL_	100±10%	0.28	9	1.2	1.3
POH3316P-151KL_	150±10%	0.40	6	1.0	1.0
POH3316P-221KL_	220±10%	0.61	5	0.80	0.80
POH3316P-331KL_	330±10%	1.02	4.5	0.60	0.60
POH3316P-471KL_	470±10%	1.27	3.5	0.50	0.50
POH3316P-681KL_	680±10%	2.02	2.5	0.40	0.40
POH3316P-102KL_	1000±10%	3.00	2.0	0.30	0.30
POH3316P-152KL_	1500±10%	4.49	1.7	0.29	0.27
POH3316P-332KL_	3300±10%	8.97	1.1	0.19	0.17

## ◆ 外形尺寸 Dimension

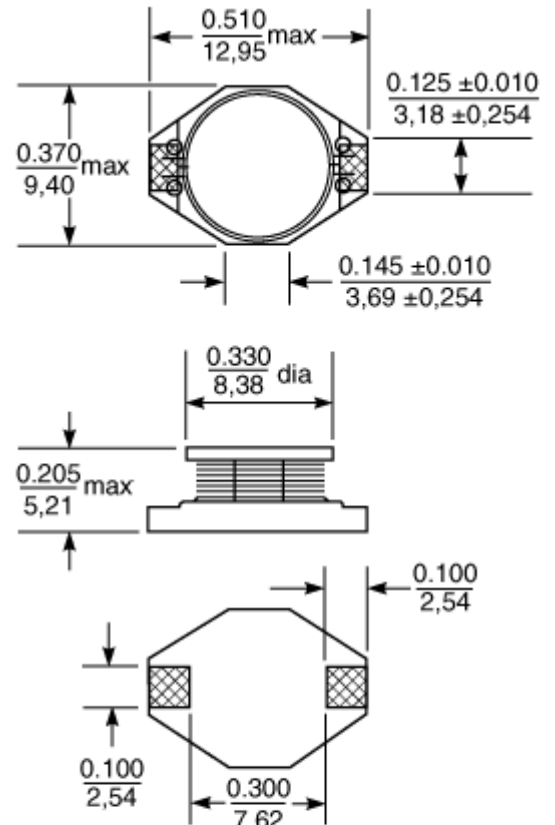

## Recommended Land Pattern

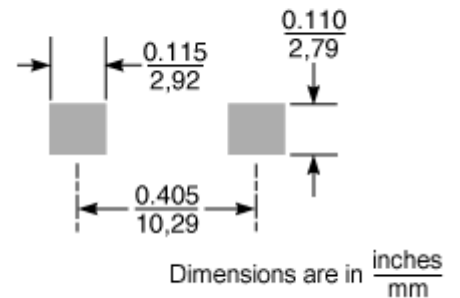

- ※ 饱和电流：电感值下降到标准值的 70% 时的电流值。  
Isat: This indicates the value of DC current when the inductance decreases to 70% of its nominal value.
- ※ 温升电流：线圈温度上升  $\Delta T=40^{\circ}\text{C}$  时的电流值（基准温度  $T_a=20^{\circ}\text{C}$ ）  
I<sub>rms</sub>: The current when temperature of coil becomes  $\Delta T=40^{\circ}\text{C}$ . ( $T_a=20^{\circ}\text{C}$ )

continued on next page 接下页

continued from previous page 接上页 POH3316P

◆ 电感值 vs 电流曲线  
**Typical L vs Current**

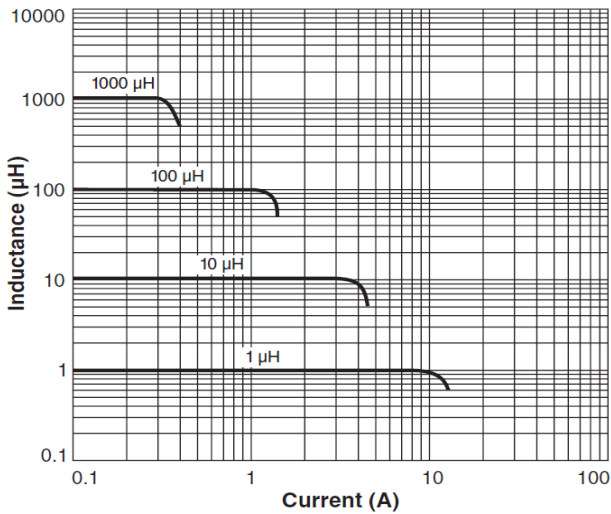

◆ 电感值 vs 频率曲线  
**Typical L vs Frequency**

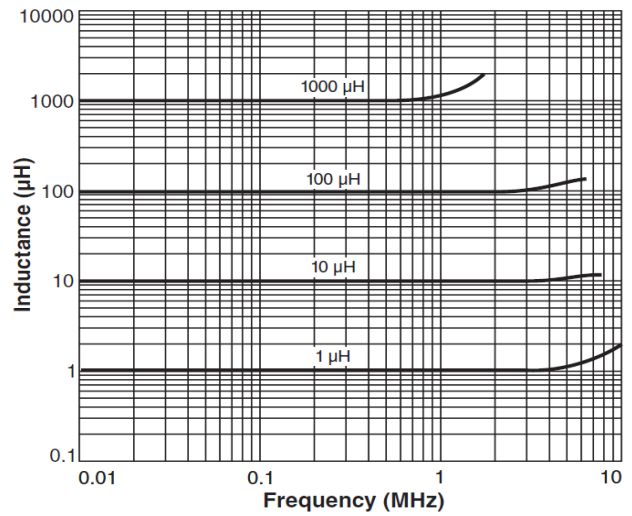

◆ 电流下降曲线  
**I<sub>rms</sub> Derating**

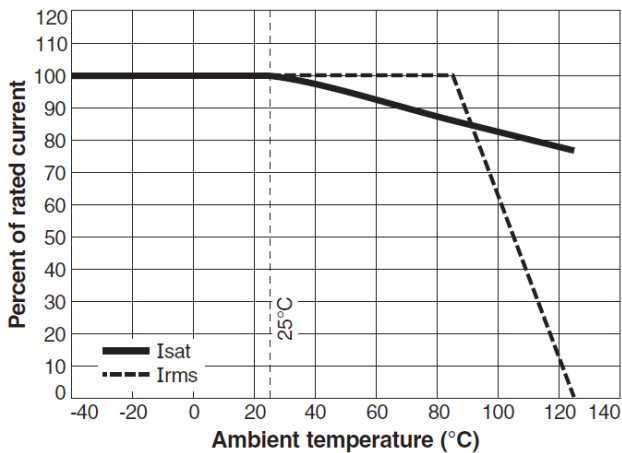

◆ 包装方式  
**Packaging**

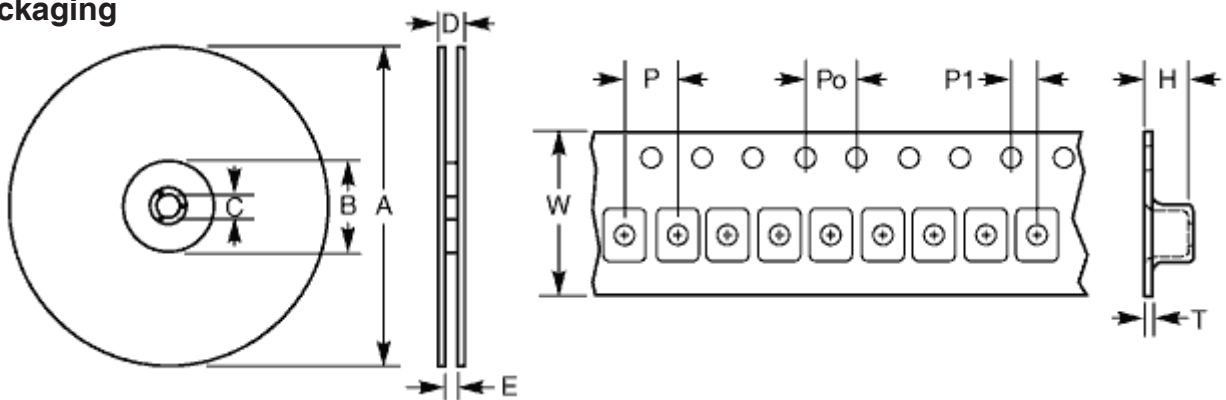

每盘数量 Parts per reel	卷盘尺寸 Reel dimensions (mm)					卷带尺寸 Tape dimensions (mm)						方向 Orientation
13" (330 mm)	A	B	C	D	E	W	P	Po	P1	H	T	
1000	330	100	13	30,4	24,4	24	12	4	2	5,8	0,33	