

PS5121



◆ 特征 Feature

- 低背型，闭磁功率电感。
Magnetically shielded, low profile power inductor.
- 饱和电流可达到 2.3 Amps；低直流电阻。
Saturation current rating up to 2.3 Amps；
low DC resistance.
- 电感值范围：2.2 to 390 μ H。
Inductance ratings from 2.2 to 390 μ H.

型号 Part number	电感量 Inductance	直流电阻 DCR	自谐频率 SRF	饱和电流 Isat	温升电流 Irms
Units	(μ H) $\pm 20\%$	(Ω) max	(MHz) typ	(A) 30% drop	(A) 40°C rise
PS5121-2R2ML_	2.2	0.050	120	2.3	2.9
PS5121-3R3ML_	3.3	0.070	90	2.0	2.3
PS5121-4R7ML_	4.7	0.095	80	1.6	1.9
PS5121-5R6ML_	5.6	0.100	73	1.5	1.8
PS5121-6R8ML_	6.8	0.110	65	1.3	1.6
PS5121-8R2ML_	8.2	0.135	55	1.2	1.5
PS5121-100ML_	10	0.160	47	1.1	1.3
PS5121-120ML_	12	0.190	41	1.0	1.2
PS5121-150ML_	15	0.280	37	0.90	1.1
PS5121-180ML_	18	0.300	35	0.87	1.0
PS5121-220ML_	22	0.330	32	0.82	0.97
PS5121-270ML_	27	0.420	27	0.74	0.85
PS5121-330ML_	33	0.480	25	0.67	0.76
PS5121-390ML_	39	0.530	23	0.58	0.73
PS5121-470ML_	47	0.750	22	0.54	0.63
PS5121-560ML_	56	0.860	19	0.49	0.60
PS5121-680ML_	68	1.00	18	0.46	0.56
PS5121-820ML_	82	1.20	15	0.42	0.47
PS5121-101ML_	100	1.40	13.5	0.35	0.44
PS5121-121ML_	120	1.60	12.0	0.32	0.42
PS5121-151ML_	150	2.10	9.0	0.31	0.38
PS5121-181ML_	180	2.31	8.5	0.27	0.34
PS5121-221ML_	220	3.10	7.5	0.25	0.29
PS5121-271ML_	270	3.50	7.0	0.22	0.27
PS5121-331ML_	330	4.00	6.5	0.20	0.26
PS5121-391ML_	390	5.00	5.8	0.19	0.21

※ 饱和电流：电感值下降到标准值的 70% 时的电流值。
Isat: This indicates the value of DC current when the inductance decreases to 70% of its nominal value.

※ 温升电流：线圈温度上升 $\Delta T=40^{\circ}\text{C}$ 时的电流值（基准温度 $T_a=20^{\circ}\text{C}$ ）
Irms: The current when temperature of coil becomes $\Delta T=40^{\circ}\text{C}$. ($T_a=20^{\circ}\text{C}$)

◆ 外形尺寸 Dimension

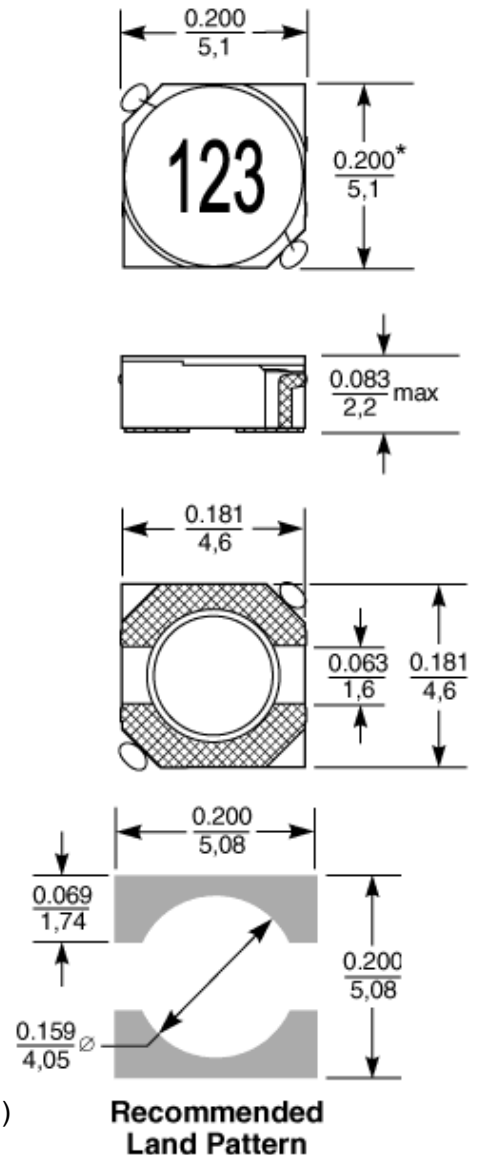

Dimensions are in $\frac{\text{inches}}{\text{mm}}$

continued on next page 接下一页

continued from previous page 接上页 PS5121

◆ 电感值 vs 电流曲线
Typical L vs Current

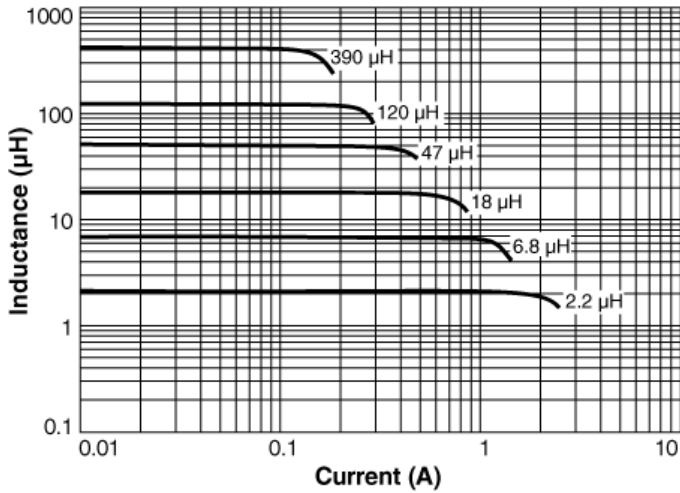

◆ 电感值 vs 频率曲线
Typical L vs Frequency

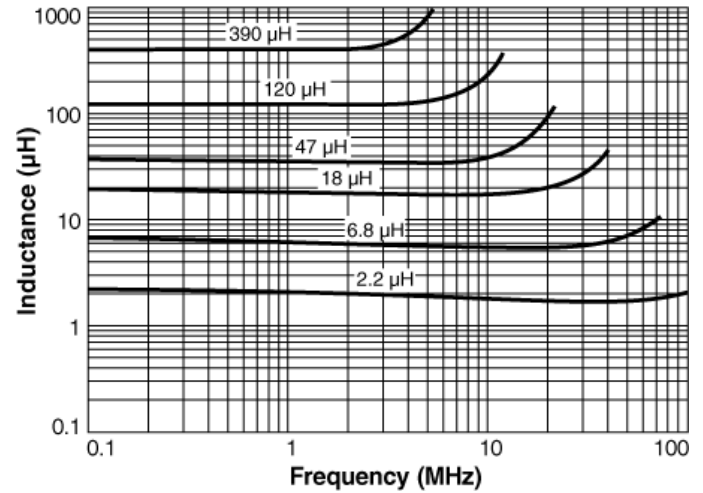

◆ 电流下降曲线
I_{rms} Derating

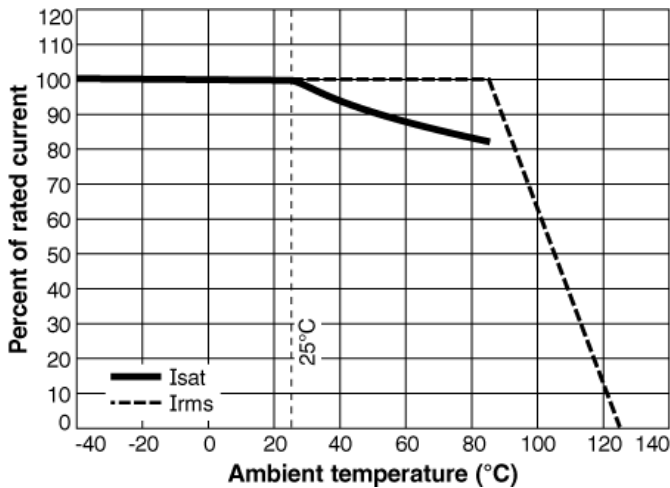

◆ 包装方式
Packaging

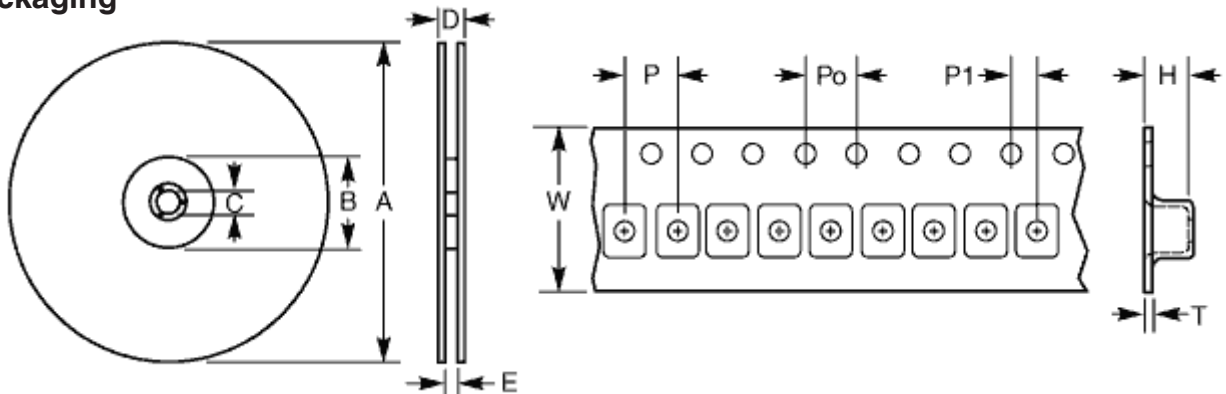

每盘数量 Parts per reel		卷盘尺寸 Reel dimensions (mm)					卷带尺寸 Tape dimensions (mm)						方向 Orientation
7" (178 mm)	13" (330 mm)	A	B	C	D	E	W	P	Po	P1	H	T	
500	2000	178/330	60/100	13	18,4	12,4	12	8	4	2	3,25	0,35	