

### GENERAL TECHNICAL CHARACTERISTICS

Reference standards : IEC 61071,60068-1  
 Dielectric : Polypropylene film  
 Construction : Dry construction, filled by solid resin,  
 Non-inductive type  
 Case : Aluminium case



### ELECTRICAL CHARACTERISTICS

Operating temperature : -40 to + 85 °C  
 Capacitance : 33 to 3200 µF  
 Rated Voltage : 700 to 4000 VDC  
 Tolerance : ± 5% ± 10%  
 Dissipation factor:  $\leq 2 \times 10^{-3}$  Measured at 100 Hz and 25 °C  
 Expected life time : 100,000 hours at Un and 70 °C (Hot-spot temperature)

### TEST METHODS AND PERFORMANCES

Test voltage between terminals : 1.5xUn for 10s at 25 °C  
 Test voltage terminal to case : (1.5×Un+1000)Vac, Min 3000Vac 60s at 25 °C  
 Insulation resistance (C\*RI) :  $\geq 10000$  s

### DESIGN

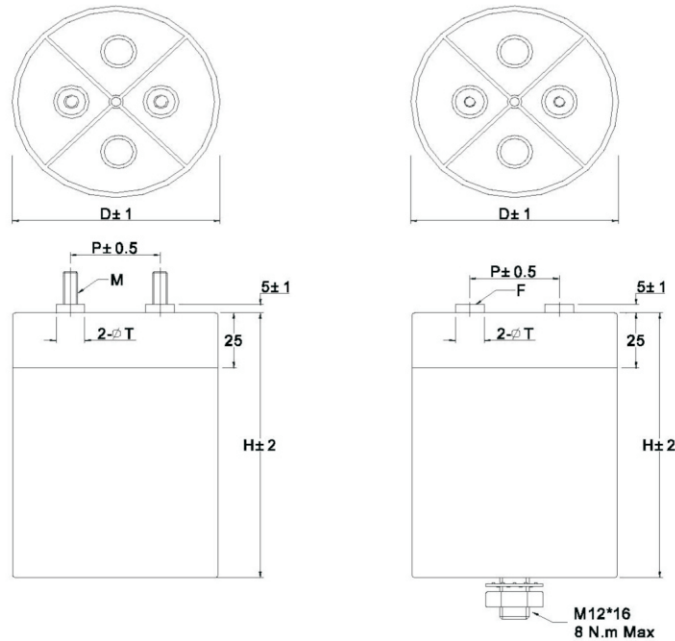

Clamp mounting

Stud mounting

D (mm)	Out put						Stud mounting	
	F	Torque	M	Torque	P (mm)	T(mm)	S	Torque
76	M6×10	4.5 N.M Max	M8×20	8.5 N.M Max	32	15	M12×16	8 N.M Max
86	M6×10	4.5 N.M Max	M8×20	8.5 N.M Max	32	15	M12×16	8 N.M Max
116	M6×10	4.5 N.M Max	M8×20	8.5 N.M Max	50	15	M12×16	8 N.M Max
136	M6×10	4.5 N.M Max	M8×20	8.5 N.M Max	50	16	M12×16	8 N.M Max

### PROTECTION AGAINST OVERVOLTAGES

1.1 × Un	30% of the service period
1.15 × Un	30 min/d
1.2 × Un	5 min/d
1.3 × Un	1 min/d
1.5 × Un	100 ms no more than 1000 times

### EXPECTED LIFE



### Electrical specifications, ordering codes

Part Number	Cap (µF)	D (mm)	H (mm)	Ipeak (KA)	Irms max. (A)	ESR (mΩ)	Ls (nH)	Rth (k/W)	Wn (Ws)	Weight (kg)
<b>Un 700V.DC</b>	<b>Us 1050V</b>	<b>Ur 200V</b>								
PCL-700-430-*#	430	76	125	3.4	62	1.1	40	3.7	105	0.75
PCL-700-450-*#	450	76	120	1.8	34	3.5	60	3.9	110	0.70
PCL-700-520-*#	520	76	145	3.1	62	1.3	45	3.2	127	0.85
PCL-700-570-*#	570	86	125	4.6	73	0.9	40	3.3	140	0.95
PCL-700-600-*#	600	86	120	2.4	41	2.7	60	3.5	147	0.90
PCL-700-650-*#	650	76	175	3.3	63	1.5	50	2.7	159	1.1
PCL-700-700-*#	700	86	145	4.2	74	1.0	45	2.9	172	1.1
PCL-700-890-*#	890	86	175	4.5	76	1.2	50	2.4	218	1.3
PCL-700-900-*#	900	76	225	3.6	65	1.9	60	2.0	221	1.3
PCL-700-1150-*#	1150	116	125	4.6	55	1.5	60	2.9	282	1.7
PCL-700-1200-*#	1200	86	225	4.8	78	1.4	60	1.8	294	1.7
PCL-700-1350-*#	1350	116	150	8.1	92	0.6	45	2.5	331	2.1
PCL-700-1700-*#	1700	116	180	8.5	93	0.7	50	2.1	417	2.4
PCL-700-2400-*#	2400	116	230	9.6	93	0.9	60	1.7	588	3.0
PCL-700-3200-*#	3200	136	230	12.8	102	0.7	60	1.5	784	4.1

Part Number	Cap (μF)	D (mm)	H (mm)	I <sub>peak</sub> (KA)	I <sub>rms max.</sub> (A)	ESR (mΩ)	L <sub>s</sub> (nH)	R <sub>th</sub> (kW)	W <sub>n</sub> (Ws)	Weight (kg)
<b>U<sub>n</sub> 900V.DC</b>		<b>U<sub>s</sub> 1350V</b>		<b>U<sub>r</sub> 200V</b>						
PCL-900-370-*	370	76	125	3.3	60	1.2	40	3.7	150	0.75
PCL-900-390-*	390	76	120	1.6	33	3.7	60	3.9	158	0.70
PCL-900-450-*	450	76	145	3.2	61	1.3	45	3.2	182	0.85
PCL-900-490-*	490	86	125	4.4	71	0.9	40	3.3	198	0.95
PCL-900-520-*	520	86	120	2.1	40	2.9	60	3.5	211	0.90
PCL-900-570-*	570	76	175	3.4	61	1.6	50	2.7	231	1.1
PCL-900-600-*	600	86	145	4.2	72	1.1	45	2.9	243	1.1
PCL-900-750-*	750	86	175	4.5	73	1.3	50	2.4	304	1.3
PCL-900-780-*	780	76	225	3.1	63	2.0	60	2.0	316	1.3
PCL-900-1000-*	1000	116	125	4.0	53	1.6	60	2.9	405	1.7
PCL-900-1050-*	1050	86	225	4.2	76	1.5	60	1.8	425	1.6
PCL-900-1100-*	1100	116	150	7.7	88	0.7	45	2.5	446	2.1
PCL-900-1450-*	1450	116	180	8.7	90	0.7	50	2.1	587	2.4
PCL-900-2000-*	2000	116	230	8.0	92	0.9	60	1.7	810	3.0
PCL-900-2750-*	2750	136	230	11.0	99	0.7	60	1.5	1114	4.1
<b>U<sub>n</sub> 1100V.DC</b>		<b>U<sub>s</sub> 1650V</b>		<b>U<sub>r</sub> 250V</b>						
PCL-1100-250-*	250	76	120	1.5	30	4.6	60	3.9	151	0.70
PCL-1100-330-*	330	86	120	2.0	36	3.6	60	3.5	200	0.90
PCL-1100-370-*	370	86	130	1.9	36	3.8	60	3.2	224	0.95
PCL-1100-400-*	400	86	145	4.0	67	1.2	45	2.9	242	1.1
PCL-1100-420-*	420	86	155	4.2	69	1.2	45	2.7	254	1.2
PCL-1100-500-*	500	86	175	4.0	67	1.5	50	2.4	303	1.3
PCL-1100-650-*	650	116	125	3.9	49	1.9	60	2.9	393	1.7
PCL-1100-680-*	680	86	225	4.1	69	1.8	60	1.8	411	1.6
PCL-1100-730-*	730	116	150	7.3	82	0.8	45	2.5	442	2.1
PCL-1100-900-*	900	136	125	5.4	54	1.4	60	2.5	545	2.3
PCL-1100-920-*	920	116	180	7.4	82	0.9	50	2.1	557	2.4
PCL-1100-1250-*	1250	116	230	7.5	84	1.1	60	1.7	756	3.0
PCL-1100-1700-*	1700	136	230	10.2	90	0.9	60	1.5	1029	4.2
PCL-1100-1900-*	1900	136	260	15.2	120	0.5	50	1.3	1150	4.7
PCL-1100-2550-*	2550	136	335	15.3	120	0.6	60	1.0	1543	6.0
<b>U<sub>n</sub> 1300V.DC</b>		<b>U<sub>s</sub> 1950V</b>		<b>U<sub>r</sub> 300V</b>						
PCL-1300-170-*	170	76	120	1.4	27	5.6	60	3.9	144	0.70
PCL-1300-230-*	230	86	120	1.8	33	4.2	60	3.5	194	0.90
PCL-1300-330-*	330	86	175	3.3	61	1.8	50	2.4	279	1.3
PCL-1300-450-*	450	116	125	3.6	45	2.3	60	2.9	380	1.7
PCL-1300-470-*	470	86	225	3.8	64	2.2	60	1.8	397	1.6
PCL-1300-500-*	500	116	150	6.5	76	0.9	45	2.5	423	2.1
PCL-1300-630-*	630	136	125	5.0	50	1.7	60	2.5	532	2.3
PCL-1300-640-*	640	116	180	6.4	77	1.0	50	2.1	541	2.4
PCL-1300-850-*	850	116	230	6.8	77	1.3	60	1.7	718	3.0
PCL-1300-900-*	900	136	180	9.0	84	0.8	50	1.9	761	3.3
PCL-1300-1200-*	1200	136	230	9.6	84	1.0	60	1.5	1014	4.1
PCL-1300-1350-*	1350	136	260	13.5	114	0.6	50	1.3	1141	4.6
PCL-1300-1800-*	1800	136	335	14.4	119	0.7	60	1.0	1521	6.0



Part Number	Cap (µF)	D (mm)	H (mm)	I <sub>peak</sub> (KA)	I <sub>rms max.</sub> (A)	ESR (mΩ)	L <sub>s</sub> (nH)	R <sub>th</sub> (kW)	W <sub>n</sub> (Ws)	Weight (kg)
<b>U<sub>n</sub> 1900V.DC</b>		<b>U<sub>s</sub> 2850V</b>		<b>U<sub>r</sub> 400V</b>						
PCL-1900-75-*#	75	76	120	1.1	22	8.4	60	3.9	135	0.70
PCL-1900-100-*#	100	86	120	1.4	27	6.3	60	3.5	181	0.90
PCL-1900-150-*#	150	86	175	2.9	51	2.6	50	2.4	271	1.3
PCL-1900-190-*#	190	116	125	2.7	36	3.4	60	2.9	343	1.7
PCL-1900-200-*#	200	86	225	2.8	52	3.3	60	1.8	361	1.7
PCL-1900-220-*#	220	116	150	5.5	65	1.2	45	2.5	397	2.1
PCL-1900-275-*#	275	136	125	3.9	41	2.4	60	2.5	496	2.3
PCL-1900-280-*#	280	116	180	5.3	64	1.5	50	2.1	505	2.4
PCL-1900-380-*#	380	116	230	5.3	65	1.8	60	1.7	686	3.0
PCL-1900-400-*#	400	136	180	7.6	71	1.1	50	1.9	722	3.3
PCL-1900-540-*#	540	136	230	7.6	72	1.3	60	1.5	975	4.1
PCL-1900-600-*#	600	136	260	11.4	99	0.8	50	1.3	1083	4.6
PCL-1900-800-*#	800	136	335	11.2	102	1.0	60	1.0	1444	6.0
<b>U<sub>n</sub> 2500V.DC</b>		<b>U<sub>s</sub> 3750V</b>		<b>U<sub>r</sub> 600V</b>						
PCL-2500-95-*#	95	116	130	1.5	43	2.5	40	2.8	297	1.8
PCL-2500-130-*#	130	136	130	2.1	47	1.9	40	2.4	406	2.5
PCL-2500-200-*#	200	116	230	1.6	42	4.4	60	1.7	625	3.0
PCL-2500-280-*#	280	136	230	2.2	46	3.2	60	1.5	875	4.1
<b>U<sub>n</sub> 3600V.DC</b>		<b>U<sub>s</sub> 5400V</b>		<b>U<sub>r</sub> 800V</b>						
PCL-3600-42-*#	42	116	130	1.3	35	3.7	40	2.8	272	1.8
PCL-3600-60-*#	60	136	130	1.8	40	2.7	40	2.4	389	2.5
PCL-3600-88-*#	88	116	230	1.2	34	6.6	60	1.7	570	3.0
PCL-3600-125-*#	125	136	230	1.8	38	4.7	60	1.5	810	4.1
<b>U<sub>n</sub> 4000V.DC</b>		<b>U<sub>s</sub> 6000V</b>		<b>U<sub>r</sub> 900V</b>						
PCL-4000-33-*#	33	116	130	1.2	33	4.2	40	2.8	264	1.8
PCL-4000-47-*#	47	136	130	1.6	37	3.0	40	2.4	376	2.5
PCL-4000-70-*#	70	116	230	1.2	32	7.4	60	1.7	560	3.0
PCL-4000-100-*#	100	136	230	1.7	36	5.3	60	1.5	800	4.1

### How to order:

PCL - 1100 - 400 - \* #

