



Gears & Fuse Gears

Miniature Fuses Clips

30A & 60A Ferrules, SDC5-SDC6



30A & 60A ferrule - fuse clips

Fuse Clips for 30 & 60 Ampere Ferrule-type Fuses

Cat. Num.	Ref. Num.	Fig.	For fuse rating/size:		Mounting details	
			Amps (max.)	Ferrule dia.	Hole Size	Screw size
CO8915P	R215479	1	30	13/32"	.172" dia.	#8
CO8919P	P217524	2	30	13/32"	.196" dia.	#10
CO8916P	V215988	3	30	9/16"	.172" dia.	#8
CO8917P	R216491	4	30 or 60	13/16"	.22" x .30"	#10
CO8918P	F217010	5	60	1-1/16"	.22" x .30"	#10

All clips are UL Recognized: Guide IZLT2, File E52283
All clips are tin-plated copper alloy, non-spring reinforced.

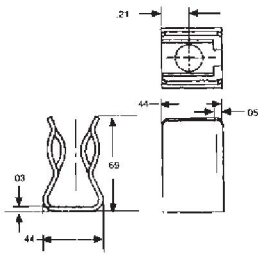

Figure 1

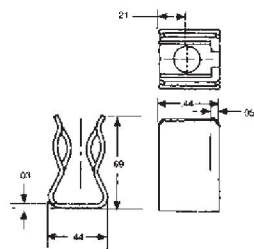

Figure 2

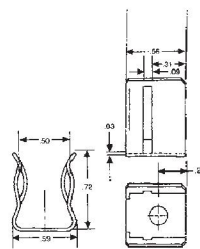

Figure 3

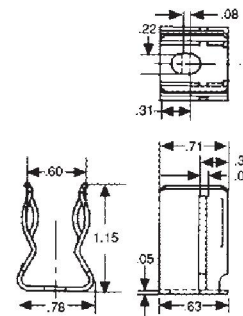

Figure 4

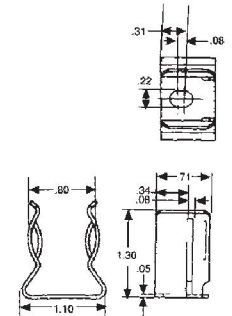
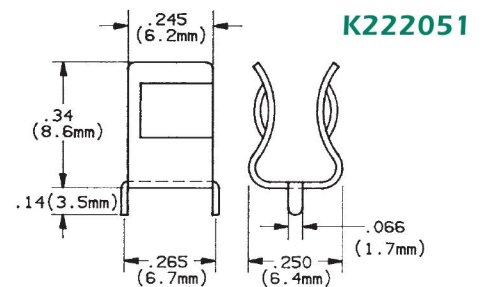

Figure 5



SDC6 PC Board clips

- PC board mount fuse clip
- For 1/4" diameter fuses
- Tin plated hard brass
- 15A maxi



SDC5 PC Board clips

- PC board mount fuse clip
- For 5mm diameter fuses
- Tin plated hard brass
- 10A maxi

R219596

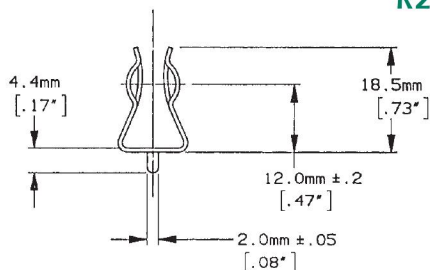

SDC7 PC Board clips

- PC board mount fuse clip
- For 13/32" (10mm) diameter fuses
- Tin plated spring brass
- 30A maxi

T222795

