

J-Z 绝缘型跨接线 Insulated Jumper Wires

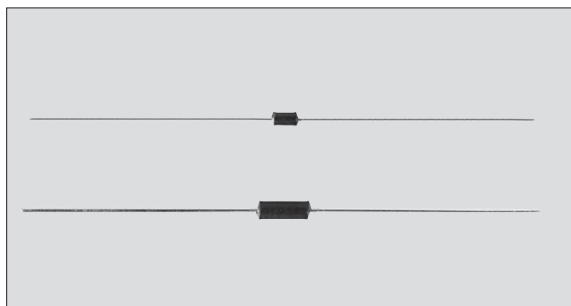

■ 结构图 Construction

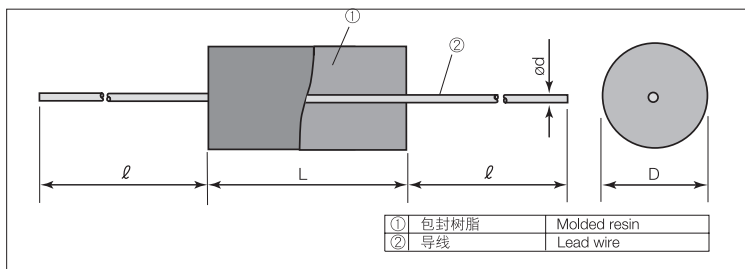

外观颜色：黑色 Body color: Black
无表示 No marking

■ 特点 Features

- 可以用于自动插装机。
- 容许电流比Z系列还大。
- 对应欧盟RoHS。
- Automatic insertion is applicable.
- Higher than Z series in allowable current.
- Products meet EU-RoHS requirements.

■ 额定值 Ratings

型号 Type	最大容许电流 Maximum Amperage	电阻值 Resistance	额定环境温度 Rated Ambient Temperature	使用温度范围 Operating Temp. Range
J1/6ZC	8A	10mΩ Max.	+70°C	-55°C~+125°C
J1/4ZC	10A			

■ 品名构成 Type Designation

实例 Example

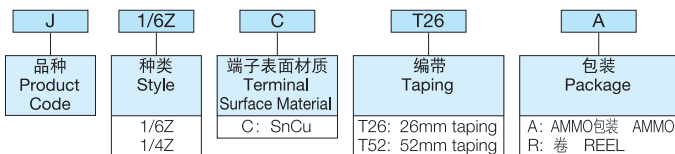

预知关于此产品含有的环境负荷物质详情(除EU-RoHS以外), 请与我们联系。
编带细节请参考卷末附录C。

Contact us when you have control request for environmental hazardous material other than the substance specified by EU-RoHS.
For further information on taping, please refer to APPENDIX C on the back pages.

■ 编带 Taping

编带类型 Taping Type Name	编带和包装数 Taping & Qty (pcs)	
	AMMO	Reel
J1/6ZCT26A	2,000	—
J1/6ZCT52□	2,000	5,000
J1/4ZCT26A	2,000	—
J1/4ZCT52□	2,000	5,000

型号中的□, 放入端子表面材质符号。
The code for package enters □.

JLI 跨接线 Jumper Wires

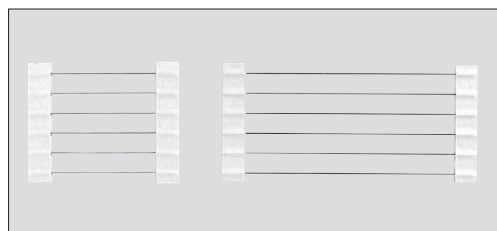

包装：无 Coating : None

■ 外形尺寸 Dimensions (mm)

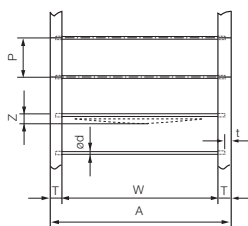

型号 Type	尺寸 Dimensions (mm)			
	W	P	A	Z
T26	26 ^{+0.1}	5.00±0.3	39±1.0	
T52	52±1	5.08±0.38	65±1.0	
	d (Nominal)	T	t	Z
T26	0.5, 0.6	6.2±0.5	2.0 Max.	0.8 Max.
T52				

■ 特点 Features

- 可以用于自动插装机, 被编带的跨接线。
- 对应欧盟RoHS。
- Automatic insertion is applicable.
- Products meet EU-RoHS requirements.

■ 额定值 Ratings

型号 Type	公称线径 Nominal Diameter	最大容许电流 Max. Allowable Current
JL5C	0.5mm	8A
JL6C	0.6mm	10A

■ 品名构成 Type Designation

实例 Example

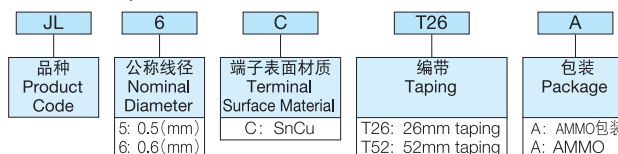

预知关于此产品含有的环境负荷物质详情(除EU-RoHS以外), 请与我们联系。
编带细节请参考卷末附录C。

Contact us when you have control request for environmental hazardous material other than the substance specified by EU-RoHS.

For further information on taping, please refer to APPENDIX C on the back pages.