

1. Features

1. This specification applies Low Profile Power Inductors.
2. 100% Lead(Pb) & Halogen-Free and RoHS compliant.

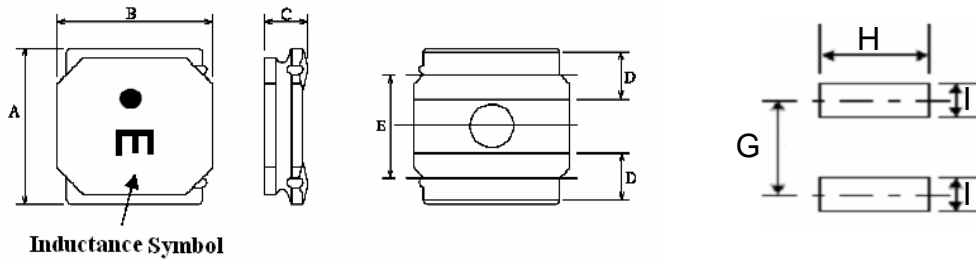

2. Dimension



| Series | A(mm) | B(mm) | C(mm) | D(mm) | E(mm) | G(mm) | H(mm) | I(mm) |
|----------|---------|---------|----------|---------|---------|----------|----------|----------|
| HPC4012B | 4.0±0.2 | 4.0±0.2 | 1.2 max. | 1.1±0.2 | 2.5±0.2 | 2.8 ref. | 3.7 ref. | 1.2 ref. |

Units: mm

3. Part Numbering

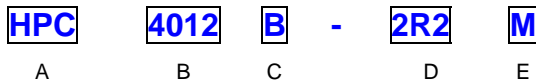

- A: Series
 B: Dimension
 C: Control S/N
 D: Inductance 2R2=2.2uH
 E: Inductance Tolerance M=±20% ; Y=±30%

4. Specification

| TAI-TECH Part Number | Inductance Symbol | Inductance (uH) | Tolerance (%) | Test Frequency (Hz) | SRF (MHz) min. | DCR (Ω) ±20% | I sat (A) | I rms (A) |
|----------------------|-------------------|-----------------|---------------|---------------------|----------------|--------------|-----------|-----------|
| HPC4012B-1R0Y | A | 1.0 | ±30% | 1V100K | 100 | 0.042 | 2.80 | 2.20 |
| HPC4012B-2R2M | C | 2.2 | ±20% | 1V100K | 70 | 0.060 | 1.65 | 1.90 |
| HPC4012B-3R3M | E | 3.3 | ±20% | 1V100K | 60 | 0.070 | 1.40 | 1.70 |
| HPC4012B-4R7M | H | 4.7 | ±20% | 1V100K | 45 | 0.095 | 1.20 | 1.50 |
| HPC4012B-6R8M | I | 6.8 | ±20% | 1V100K | 35 | 0.125 | 0.90 | 1.30 |
| HPC4012B-100M | K | 10 | ±20% | 1V100K | 30 | 0.170 | 0.80 | 1.10 |
| HPC4012B-150M | M | 15 | ±20% | 1V100K | 24 | 0.260 | 0.65 | 0.75 |
| HPC4012B-220M | N | 22 | ±20% | 1V100K | 18 | 0.400 | 0.50 | 0.62 |

Note:

- Isat : Based on inductance change (ΔL/L0 : ≤-30%) @ ambient temp. 25°C
 Irms : Based on temperature rise (ΔT : 40°C typ.)