

### 1. Features

1. This specification applies Low Profile Power Inductors.
2. 100% Lead(Pb) & Halogen-Free and RoHS compliant.

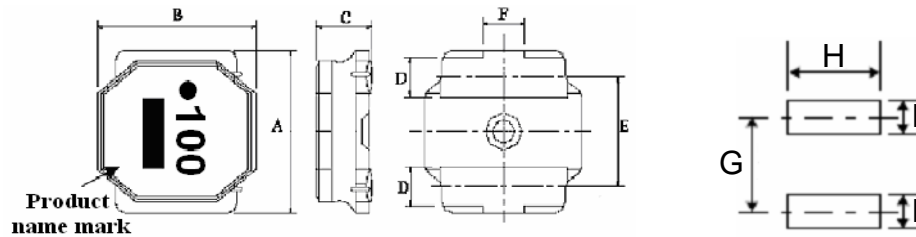

### 2. Dimension



Series	A(mm)	B(mm)	C(mm)	D(mm)	E(mm)	F(mm)	G(mm)	H(mm)	I(mm)
HPC6010B	6.0±0.2	6.0±0.2	1.0 max.	1.35±0.2	4.0±0.2	2.3 typ.	4.7 ref.	5.7 ref.	1.6 ref.

Units: mm

### 3. Part Numbering

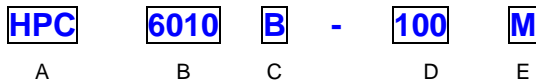

- A: Series  
 B: Dimension  
 C: Control S/N  
 D: Inductance                      100=10.0uH  
 E: Inductance Tolerance        M=±20% ; Y=±30%

### 4. Specification

TAI-TECH Part Number	Inductance (uH)	Tolerance (%)	Test Frequency (Hz)	SRF (MHz) min.	DCR (Ω) ±20%	I sat (A)	I rms (A)
HPC6010B-1R5M	1.5	±20%	1V100K	77	0.090	2.40	1.90
HPC6010B-2R2M	2.2	±20%	1V100K	56	0.110	1.90	1.70
HPC6010B-3R3M	3.3	±20%	1V100K	42	0.135	1.60	1.50
HPC6010B-4R7M	4.7	±20%	1V100K	36	0.165	1.30	1.40
HPC6010B-6R8M	6.8	±20%	1V100K	30	0.220	1.20	1.20
HPC6010B-100M	10	±20%	1V100K	25	0.270	1.00	1.10
HPC6010B-220M	22	±20%	1V100K	12	0.580	0.65	0.70

Note:

- Isat : Based on inductance change (ΔL/L0 : ≤-30%) @ ambient temp. 25°C  
 I rms : Based on temperature rise (ΔT : 40°C typ.)