

### 1. Features

1. This specification applies Low Profile Power Inductors.
2. 100% Lead(Pb) & Halogen-Free and RoHS compliant.

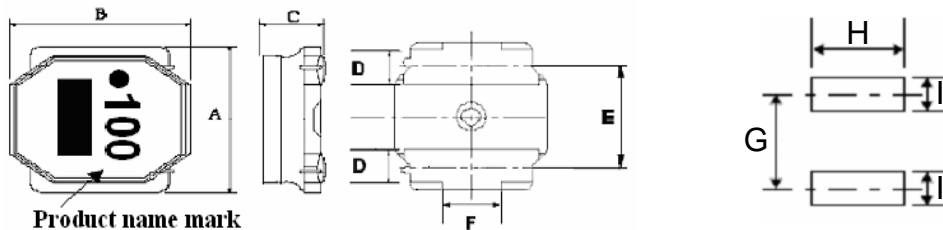

### 2. Dimension



Series	A(mm)	B(mm)	C(mm)	D(mm)	E(mm)	F(mm)	G(mm)	H(mm)	I(mm)
HPC6012B	6.0±0.2	6.0±0.2	1.2 max.	1.35±0.2	4.0±0.2	2.3 typ.	4.7 ref.	5.7 ref.	1.6 ref.

Units: mm

### 3. Part Numbering

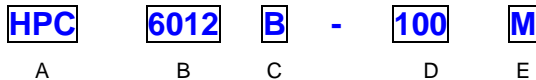

- A: Series  
 B: Dimension  
 C: Control S/N  
 D: Inductance                      100=10.0uH  
 E: Inductance Tolerance          M=±20% ; Y=±30%

### 4. Specification

TAI-TECH Part Number	Inductance (uH)	Tolerance (%)	Test Frequency (Hz)	SRF (MHz) min.	DCR (Ω) ±20%	I sat (A)	I rms (A)
HPC6012B-2R5Y	2.5	±30%	1V100K	45	0.090	2.10	1.80
HPC6012B-3R3Y	3.3	±30%	1V100K	42	0.105	1.80	1.70
HPC6012B-4R7M	4.7	±20%	1V100K	36	0.125	1.60	1.55
HPC6012B-5R3M	5.3	±20%	1V100K	34	0.125	1.50	1.55
HPC6012B-6R8M	6.8	±20%	1V100K	30	0.165	1.30	1.35
HPC6012B-100M	10	±20%	1V100K	22	0.200	1.00	1.20
HPC6012B-150M	15	±20%	1V100K	18	0.295	0.80	0.80
HPC6012B-220M	22	±20%	1V100K	12	0.465	0.76	0.65
HPC6012B-330M	33	±20%	1V100K	8	0.580	0.59	0.55
HPC6012B-470M	47	±20%	1V100K	6	0.965	0.52	0.46
HPC6012B-680M	68	±20%	1V100K	3	1.160	0.44	0.41
HPC6012B-101M	100	±20%	1V100K	1	1.670	0.35	0.32

Note:

I<sub>sat</sub> : Based on inductance change (ΔL/L0 : ≤-30%) @ ambient temp. 25°C

I<sub>rms</sub> : Based on temperature rise (ΔT : 40°C typ.)