

LPA 轮辐式力传感器

特点和用途/Feature and Applications

- 结构简单安装方便快捷
 - 合金钢或不锈钢轮辐结构
 - 硅胶密封或焊接密封防水性能好
 - 整理法兰固定，中间螺纹台阶受力
- 主要应用:试验机，压装机，油压机，冷热压机，电子吊钩秤料斗秤等各类电子称重设备和拉压力检测设备。

- Simple structure, easy to install,
 - Alloy steel or stainless steel compression,
 - seal with gel or by laser welding, good water proof fixed by flange ,force applied on thread step in the middle.
- Application:mainly applied testing machine, Pressing machine, hydraulic machine, Cold and hot press and crane scale, etc.

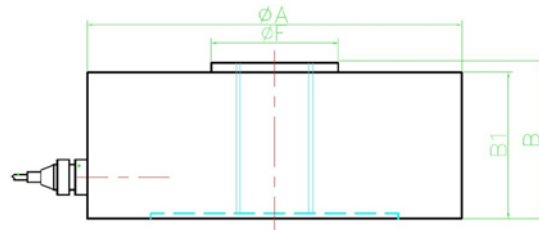
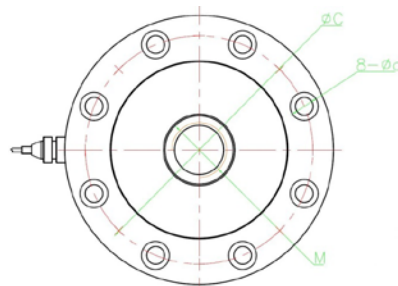

量程/Capacity : 0.5~200T

Capacity(T)	A	B	B1	C	D	F	M
0.5~7	105	37	34	89	6.5	32	M16*1.5 OR 5/8-18UNF
10~25	125	56	46	101.8	8.6	39	M30*1.5 OR 1-1/4-12UNF
30~50	145	65	54	116.8	10.5	60	M40*1.5 OR 1-3/4-12UNF
60~100	205	85	73	162	12.5	76	M60*2
150~200	296	125	115	246	21	148	M110*3

规格参数 Specification			
输出灵敏度 Rated Output	2.0 ± 5% mV / V	输出电阻 Output Impedance	700 ± 5 Ω
零点输出 Zero Balance	± 2 % F.S.	绝缘电阻 Insulation	≥5000MΩ/100VDC
非线性 Non-linearity	0.05 % F.S	使用电压 Recodmmed Excitation	5-10V
滞后 Hyteresis	0.05 % F.S	最大电压 Maximum Excitation	10V
重复性 Repeatability	0.05 % F.S	温度补偿 CompensatedTemp Range	- 10 ~ 60 °C
蠕变 (30 分钟) Creep (30min)	0.05 % F.S	工作温度 Operation Temp Range	- 20 ~ 80 °C
灵敏温漂 Temp Effect on Output	0.025 % F.S. / 10°C	安全超载 Safe Overload	150%
零点温漂 Temp Effect on Zero	0.025 % F.S. / 10°C	极限超载 Ultimate Overload	200%
输入电阻 Input Impedance	750 ± 10 Ω	防护等级 Protection Class	IP67
		电缆线尺寸 Cable Size	∅ 5 x6m
电缆线连接方式 Wire Connection	Ex + : Red; Ex - : Black; Output + : Green; Output - : White		
	输入 + : 红 输入 - : 黑 输出 + : 绿 输出 - : 白		