



带卡栓锁紧
With bayonet locking.

采用特殊弹片
Adopt special shrapnel



在未插合状态下防触摸保护
Touch protected in unplugged condition



绝缘层上清晰可见的颜色标记
Clearly visible colour marking
on the insulation

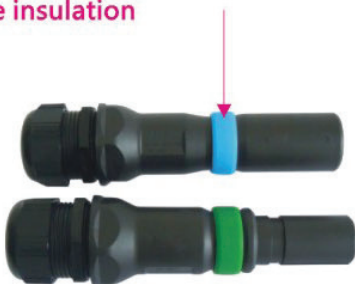

插合状态下IP65
IP65 in mated condition



可以配备一个微动开关显示锁紧状态
Can be equipped with a mi-croswitch
as locking status in-dication
(according to IEC 61948)



I 技术参数 Technical Parameters

额定电流 (安培) / Rated current (Amperes)	300A
额定电压 (伏特) / Rated voltage (Volts)	1000V
连接线径尺寸 (AWG) / Contact Barrel Wire Size (AWG)	50~150mm ²
接触材料 / Contact material	铜、镀银copper Plate with silver
绝缘材料 / Insulation material	PA
防火等级 / Flammability	UL94 V-0
寿命/Life a.空载状态 (连接/断开次) Without load (Contact/Disconnect Cycles) b.负载状态 (热插拔250&120V) With Load (Hot Plug 250 Cycles& 120V)	To 5,000 NO
接触电阻(微欧) / average Contact Resistance(micro-ohms)	20
绝缘电阻 / Insulation Resistance	5000MΩ
平均插拔力(牛顿) / average. Connection\disconnect(N)	120N
环境温度 (°C) / Environment Temperature (°C)	-20°C...+75°C
耐压/ Insulation Withstanding Test Voltage(Volts AC/DC)	3000V AC

I 板端工业连接器

Board interface industrial connector

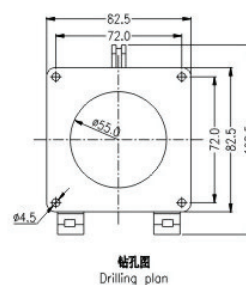
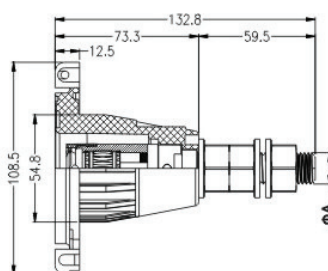

插头料号 Plug P/N	导体截面积(mm ²) Conductor cross section (mm ²)	插座标称直径ΦA(mm) Nominal dia. Socket ΦA(mm)	颜色标记 coloured marking
FIC300B01-*A	50~70mm ²	12	
FIC300B02-*A	95~120mm ²	14	
FIC300B03-*A	150mm ²	16	

I 线端工业连接器/Wire interface industrial connector

I 配件/Accessories



保护盖 Protective cover

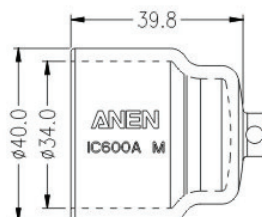

插头料号 Plug P/N	导体截面积(mm ²) Conductor cross section (mm ²)	压接套内径ΦA (mm) Dimensions ΦA(mm)	压接套外径ΦB (mm) Dimensions ΦB(mm)	颜色标记 coloured marking
FIC300M01-*A	50~70mm ²	12.5	17.5	
FIC300M02-*A	95~120mm ²	16.0	21.0	
FIC300M03-*A	150mm ²	18.0	23.0	

I 线端工业连接器

Wire interface industrial connector

颜色标记 Coloured marking

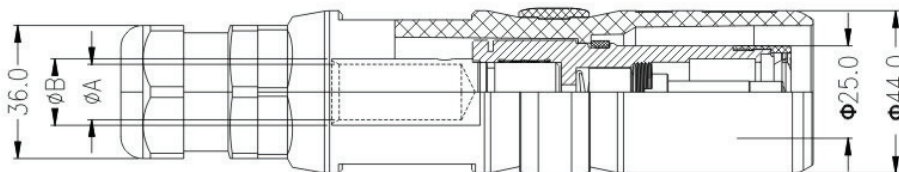

I 配件/Accessories

保护盖 Protective cover

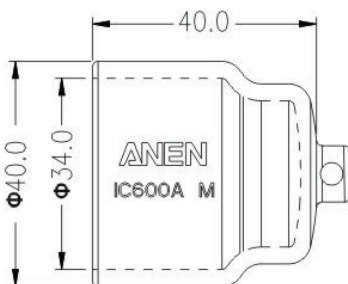

插头料号 Plug P/N	导体截面积(mm ²) Conductor cross section (mm ²)	压接套内径 Φ A (mm) Dimensions Φ A(mm)	压接套外径 Φ B (mm) Dimensions Φ B(mm)	颜色标记 coloured marking
FIC300F01-*A	50~70mm ²	12.5	17.5	1 2 3
FIC300F02-*A	95~120mm ²	16.0	21.0	4 5
FIC300F03-*A	150mm ²	18.0	23.0	