

THE INFORMATION ON THIS DRAWING IS THE PROPERTY OF CELESTRA CORPORATION. IS DISCLOSED IN CONFIDENCE AND IS NOT TO BE REPRODUCED, USED OR DISCLOSED EXCEPT FOR THE PURPOSE FOR WHICH FURNISHED

CELESTRA CAT NO.	WIRE SIZE		BOLT SIZE	B	C	D	F	G	H	ID
	CODE	FLEX		MIN	±0.04	±0.01	±0.02	±0.01	±0.04	±0.01
DB101458A-250	1/0 AWG	225/24	1/4	1.33	0.76	0.12	0.32	0.63	0.94	0.39

**NOTE:**

- ALL DIMENSIONS ARE IN INCH UNLESS OTHERWISE SPECIFIED.
- ALL DA, DB, LA, LB, WP, AND J SERIES OF CAT. NO.S ARE LISTED BY "UNDERWRITERS INC" AND "CSA" FOR USE ON CODE WIRES AND FLEX/24 STRANDED CABLES.

PRE-FIX CAT.NO. WITH "L" HAS NOT PEEP HOLE UNLESS OTHERWISE SPECIFIED IN THE SUFFIX OF THE CAT.NO. WITH "P"

**MATERIAL:** HIGH CONDUCTIVITY WROUGHT COPPER

**FINISH:** ELECTRO-TIN PLATE UNLESS OTHERWISE SPECIFIED PER MIL-T-16366 SUFFIX CAT. NO. WITH "SP" FOR SILVER.

INSTALLATION GUIDE  
DIE CODE=42  
DIE COLOR=PINK



Cust.P/N: /

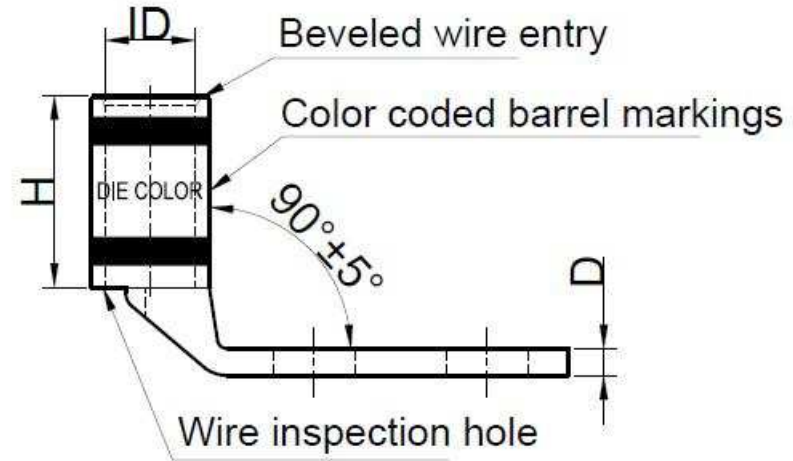
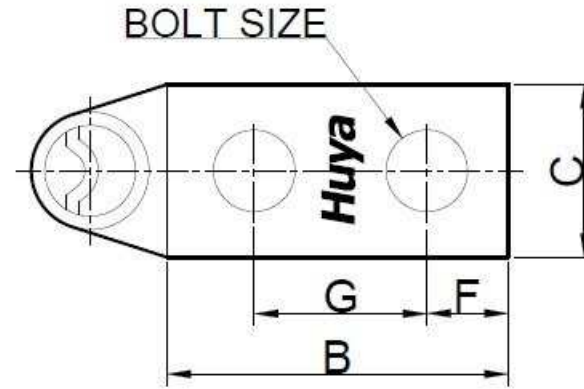

REV	DATE	DWN	CHK	DESCRIPTION	ECN
00	20-Nov-12	IRIS JIAN	SINIA QIU	Celestra Standards Spec. Initialed.	N/A

**Huya**<sup>®</sup>

**CELESTRA CORPORATION**  
76. ZHONGSI HUANCUN ROAD, ZHONGCUN TOWN.  
PANYU DIST, GUANGZHOU, 51 1495 CHINA  
www.celestra.cn

TITLE: WIRE CONNECTORS AND SOLDERING LUGS FOR CODE AND FLEX CABLE					
MATERIAL: HIGH CONDUCTIVITY WROUGHT COPPER		PRT NO. DB101458A-250		SCALE NTS	
FINISH: ELECTRO-TIN PLATE		DWG NO. 186-30121120		UNIT INCH	

